

ORDINANCE No. 966

AN ORDINANCE OF THE CITY OF RED LODGE, MONTANA, ESTABLISHING THE RED LODGE AIRPORT BOUNDARY

WHEREAS, The City of Red Lodge has determined that a formal Boundary of the Red Lodge Airport has not been previously established; and

WHEREAS, The City of Red Lodge has determined that a formal Boundary of the Red Lodge Airport is necessary and proper in order to maintain and operate said Airport.

NOW THEREFORE BE IT ORDAINED BY THE CITY COUNCIL OF THE CITY OF RED LODGE, MONTANA, AS FOLLOWS:

1. The Red Lodge Airport boundary is hereby established by a survey that will be prepared by a licensed surveyor with staff accompaniment and shall after be recorded at the Carbon County Clerk and Recorder.
2. Said survey shall consist of the outside boundary of the airport and will be the formal Boundary of the Red lodge Airport.
3. Said Survey shall follow the attached map. The Survey to be prepared hereafter is incorporated herein by reference and shall be the formal boundary of the Red Lodge Airport.
4. In the case of a conflict between the attached map and the final Survey, the final Survey that is recorded at the Carbon County Clerk and Recorder shall control.

The Ordinance shall be effective 30-days after approval of second reading by the City Council of the City of Red Lodge, Montana.

First Reading by the Council on the 14th day of November, 2023.

Second Reading by the Council on the 28th day of November, 2023.

PASSED and APPROVED this 28th day of November, 2023.

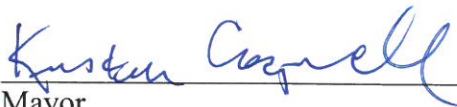

Mayor

ATTEST:



City Clerk

AS BUILT MAP OF RED LODGE AIRPORT
LYING IN E1/2 OF SECTION 27 AND THE NW1/4 OF SECTION 34, T.7S., R.20E., P.M.M.,
CARBON COUNTY, MONTANA

PREPARED BY: RED LODGE SURVEYING LLC
DURING: MARCH OF 2023

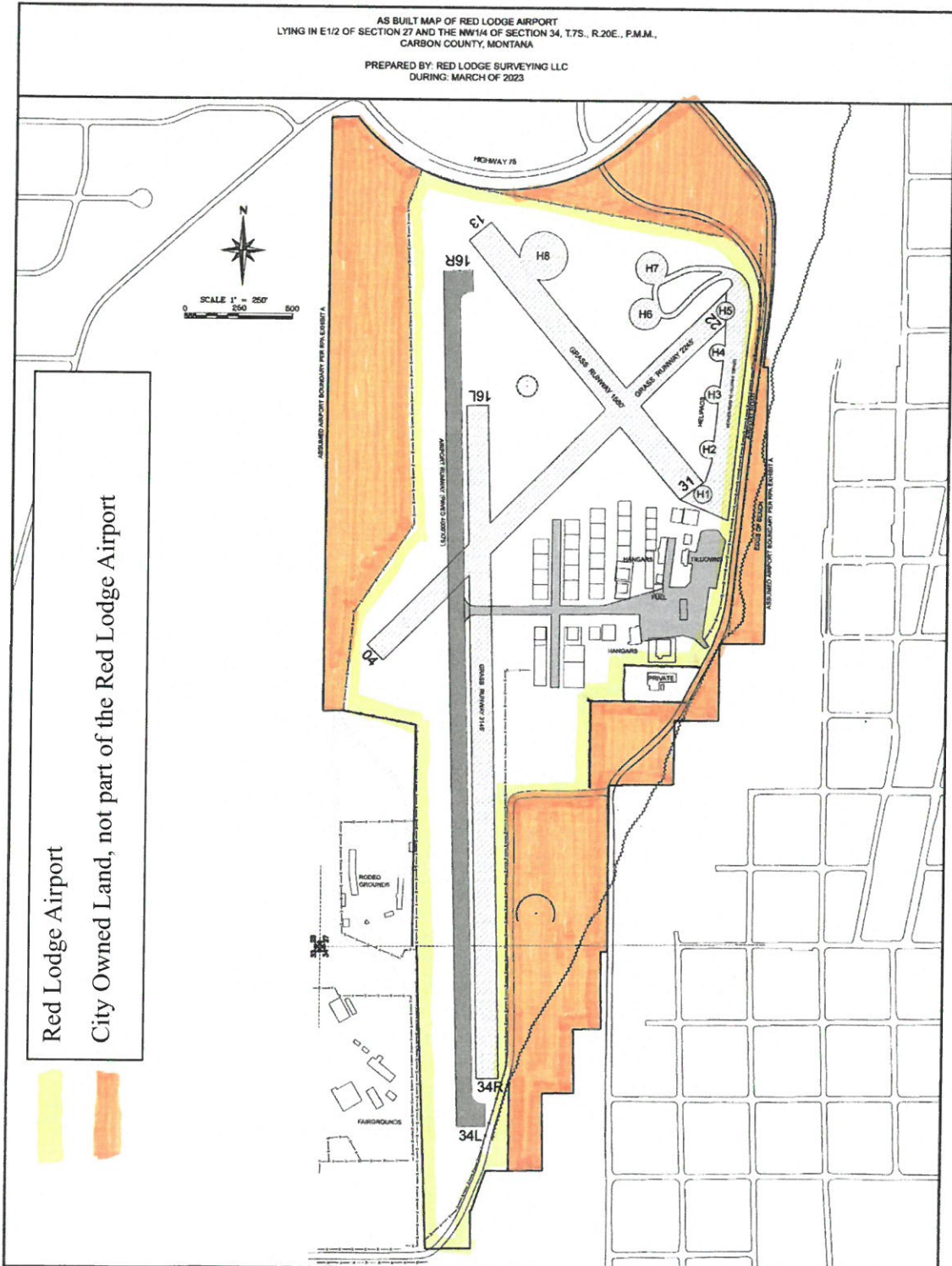

INTER-LOCAL AGREEMENT FORMATION, AUTHORITY AND ADMINISTRATION OF ABATEMENT REGION 3 FOR THE OPIOID SETTLEMENT

This Interlocal Agreement (Agreement) is made pursuant to Title 7, Chapter 11, Part I, Montana Code Annotated on the tenth date of January, 2024 (Effective Date) between Big Horn County, Carbon County, Stillwater County, Sweet Grass County, Wheatland County, Judith Basin County, Fergus County, Petroleum County, Musselshell County, and Golden Valley County (collectively the “Parties”).

ARTICLE I - PURPOSE

The purpose of this Agreement is to establish the governance structure for the administration, management, and use of Opioid Remediation Funds that the Parties are entitled to receive as a part of a Settlement Agreement (Settlement Agreement) outlined in a Memorandum of Understanding (MOU) with the Attorney General, a copy of which is attached to this Agreement.

ARTICLE II- DURATION and TERMINATION

The terms and conditions of this Agreement shall become effective on the Effective Date of this Agreement. The term of this Agreement is two years from the Effective Date and may be extended for additional one-year periods, not to exceed ten years. This Agreement may be mutually terminated at any time, by any party, providing thirty (30) calendar days written notice of termination.

ARTICLE III-CREATION OF ENTITY

- A. CREATION OF REGION THREE MULTI-COUNTY OPIOID ABATEMENT REGION
- (1) By entering this Agreement, the Parties create the Region Three Multi-County Opioid Abatement Region (Abatement Region Three).
 - (2) Abatement Region Three shall have the responsibility to make decisions about planning, budgeting, and disbursement of funds for projects that will equitably and appropriately serve the needs of the entire Region to be consistent with the MOU and the Settlement Agreement's definition and description of appropriate Opioid Remediation and Approved Purposes.
 - (3) Abatement Region Three shall consist of ten (10) members, one appointed from each county who is a party to this Agreement. The members shall elect a presiding officer and shall hold regular meetings at least annually and special meetings as necessary,
 - (4) Abatement Regional Three designates Big Horn County as the Fiscal Agent as it relates to the Opioid Remediation Funds and the MOU and may on behalf of Abatement Region Three, submit claims, requests for disbursements, accountings of spending and any other financial reports or matters as it relates to these funds. The fiscal agent may withhold up to 5% of each grant award for administrative costs.

ARTICLE IV-GENERAL PROVISIONS

1. ASSIGNMENT and AUTHORITY

No party shall assign, transfer, or convey any right or obligation set forth in this Agreement without the prior written consent of the other parties. The undersigned represent that they have authority to enter this Agreement.

2. COMPLETE AGREEMENT

This Agreement constitutes the sole and entire agreement between the Parties with regard to the subject matter hereof. No other terms or conditions shall be binding upon any party unless accepted in writing. This Agreement supersedes any previous oral or written agreements between the Parties with regard to the subject matter hereof.

3. APPLICABLE LAW, VENUE and ATTORNEYS FEES

This Agreement shall be governed by the laws of the State of Montana and any action to enforce any right or obligation shall be brought in the Fourteenth Judicial District, Musselshell County. The prevailing party in any action to enforce this Agreement shall be entitled to attorney's fees.

4. COMPLIANCE WITH LAW

The Parties shall comply with all applicable federal, state, and local laws in performing under this Agreement.

5. SEVERABILITY

The provisions of this Agreement shall be deemed independent and severable, and the invalidity, partial invalidity, or unenforceability of any one provision or portion thereof shall not affect the validity or enforceability of any other provision of this Agreement.

6. RECORDING

All parties will be responsible for filing an executed copy of this Agreement with the Big Horn County, Montana Clerk and Recorder, the Carbon County, Montana Clerk and Recorder, the Stillwater County, Montana Clerk and Recorder, the Sweet Grass County, Montana Clerk and Recorder, the Wheatland County, Montana Clerk and Recorder, the Golden Valley County, Montana Clerk and Recorder, the Musselshell County, Montana Clerk and Recorder, the Judith Basin County, Montana Clerk and Recorder, the Fergus County, Montana Clerk and Recorder, the Petroleum County, Montana Clerk and Recorder, and the Secretary of State pursuant to 7-11-107, MCA. Cost of filing will be shared equally.

7. INTERLOCAL AGREEMENT

This Agreement is an interlocal agreement under Section 7-11-104. M.C.A. To that end, this Agreement shall remain in effect at least through the date stated in Article II

above, unless earlier terminated under the provisions hereof or by the agreement of the Parties. As an agreement amongst recognized government entities and political subdivisions, no partnership or joint venture is intended nor exists nor shall be deemed to exist between the Parties.

This Agreement entered on the Effective Date by:

BIG HORN COUNTY, MONTANA

Chairman, Board of County Commissioners

STILLWATER COUNTY, MONTANA

Chairman, Board of County Commissioners

WHEATLAND COUNTY, MONTANA

Chairman, Board of County Commissioners

MUSSELSHELL COUNTY, MONTANA

Chairman, Board of County Commissioners

FERGUS COUNTY, MONTANA

Chairman, Board of County Commissioners

CARBON COUNTY, MONTANA

Chairman, Board of County Commissioners

SWEET GRASS COUNTY, MONTANA

Chairman, Board of County Commissioners

GOLDEN VALLEY COUNTY, MONTANA

Chairman, Board of County Commissioners

JUDITH BASIN COUNTY, MONTANA

Chairman, Board of County Commissioners

PETROLEUM COUNTY, MONTANA

Chairman, Board of County Commissioners

MACo

Member	Name	Building Description	Year Built
Carbon County	Offsite - Carbon County		
Carbon County	Courthouse	Courthouse	1898
Carbon County	Courthouse - Admin Offices	Courthouse - Admin Offices	1970
Carbon County	Radio Booster Station	Radio Booster Station	1985
Carbon County	Radio Repeater, South Bridger	Radio Repeater, South Bridger	1972
Carbon County	TV Transmitter Building & Tower	TV Transmitter Building & Tower	1980
Carbon County	Courthouse - Storage/Old Jail	Courthouse - Storage / Old Jail	1920
Carbon County	Bridger Road - Shop #1	Bridger Road - Shop	2000
Carbon County	Bridger Road - Shop #2	Bridger Road - Shop #2	1960
Carbon County	Bridger Road - Storage Shed	Bridger Road - Storage Shed	2000
Carbon County	Bridger Road - Sign Shed	Bridger Road - Sign Shed	2003
Carbon County	Bridger Road - Railroad Car Storage	Bridger Road - Railroad Car Storage	1960
Carbon County	Bridger Road - Fueling Station	Bridger Road - Fueling Station	1990
Carbon County	Joliet Road - Shop & Extension Office	Joliet Road - Shop & Extension Office	2012
Carbon County	Joliet Road - Old Shop	Joliet Road - Old Shop	1965
Carbon County	Joliet Road - Garage & Warehouse	Joliet Road - Garage & Warehouse	1960
Carbon County	Joliet Road - Storage Building	Joliet Road - Storage Building	1960
Carbon County	Road Shop	Road Shop	2010
Carbon County	Road Shop, Quonset	Road Shop, Quonset	1975
Carbon County	Road Garage Storage	Road Garage Storage	1960
Carbon County	Road Sign Storage	Road Sign Storage	1950
Carbon County	Fueling Station	Fueling Station	1990
Carbon County	Weed Control - Office	Weed Control - Office	1998
Carbon County	Weed Control - Tank Storage	Weed Control - Tank Storage	1989
Carbon County	Weed Control - Sprayer Storage	Weed Control - Sprayer Storage	1994
Carbon County	Cemetery Tool Shed	Cemetery Tool Shed	1950
Carbon County	Storage Garage	Storage Garage	1960
Carbon County	Cemetery Tool Shed	Cemetery Tool Shed	1950
Carbon County	Belfry Cemetery Tool Shed	Cemetery Tool Shed	1960
Carbon County	Cemetery Tool Shed	Cemetery Tool Shed	1960
Carbon County	Cemetery Tool Shed	Cemetery Tool Shed	1960
Carbon County	Edgar Gruel Building	Home Economics Building	1980
Carbon County	Animal Show Barn	Animal Show Barn	1980
Carbon County	Hog/Sheep Barn	Hog/ Sheep Barn	1985
Carbon County	Horse Barn	Horse Barn	1985
Carbon County	Horse Stall Cover	Horse Stall Cover	2012
Carbon County	EOC/Poultry Building	EOC/ Poultry Building	2011
Carbon County	Fair Office	Fair Office	1980
Carbon County	Extension Office	Extension Office	1920
Carbon County	Steel Snowplow Garage	Steel Snowplow Garage	2013
Carbon County	Office Building	Office Building	1960
Carbon County	Vacant Land - Tract 1-C 1 COS982	Vacant Land - Parcel No: 1619600	
Carbon County	Radio Repeater - Rock Creek Tower	Radio Repeater - Rock Creek Tower	
Carbon County	Radio Repeater - Greeno Tower	Radio Repeater - Greeno Tower	
Carbon County	Radio Repeater - Shane Ridge	Radio Repeater - Shane Ridge	
Carbon County	Road Shop - Wooden Shed	Red Lodge Road Shop - Wooden Shed	2021
Carbon County	BELFRY - CEMETERY PAVILION	BELFRY - CEMETERY PAVILION	2019

Carbon County	BRIDGER - CEMETERY SHOP	BRIDGER - CEMETERY SHOP	2013
Carbon County	BRIDGER - CEMETERY PAVILION	BRIDGER - CEMETERY PAVILION	2019
Carbon County	SAND SHED	JOLIET ROAD - SAND SHED	2019
Carbon County	New Admin Building	Old Cedarwood Building	1975

Building Export Report

Location Number	Active Date	Not Covered	Inactive Date
CB05- 1			
CB05-001		False	
CB05-002		False	
CB05-003		False	
CB05-005		False	
CB05-007		False	
CB05-008		False	
CB05-015		False	
CB05-016		False	
CB05-017		False	
CB05-018		False	
CB05-019		False	
CB05-020		False	
CB05-021		False	
CB05-022		False	
CB05-023		False	
CB05-024		False	
CB05-025		False	
CB05-026		False	
CB05-027		False	
CB05-028		False	
CB05-029		False	
CB05-030		False	
CB05-031		False	
CB05-032		False	
CB05-033		False	
CB05-034		True	
CB05-035		False	
CB05-036		False	
CB05-037		False	
CB05-038		False	
CB05-039		False	
CB05-040		False	
CB05-041		False	
CB05-042		False	
CB05-043		False	
CB05-044		False	
CB05-045		False	
CB05-046		False	
CB05-047		False	
CB05-049		False	
CB05-050	1/4/2021	True	
CB05-051	2/9/2021	False	
CB05-052	2/9/2021	False	
CB05-053	2/9/2021	False	
CB05-054	5/20/2021	False	
CB05-058	9/20/2022	True	

CB05-059	9/20/2022	True	
CB05-060	9/20/2022	True	
CB05-061	9/20/2022	True	
CB05-062	12/2/2022	False	
51			

Street1	Street2	City
100 NORTH BROADWAY AVENUE		RED LODGE
17 11TH STREET W		RED LODGE
116 RED LODGE MOUNTAIN		RED LODGE
26 WEBBER LANE		BRIDGER
26 WEBBER LANE		BRIDGER
100 NORTH BROADWAY AVENUE		RED LODGE
22 OLD MINE ROAD		BRIDGER
22 OLD MINE ROAD		BRIDGER
22 OLD MINE ROAD		BRIDGER
22 OLD MINE ROAD		BRIDGER
22 OLD MINE ROAD		BRIDGER
22 OLD MINE ROAD		BRIDGER
201 STATE STREET		JOLIET
201 STATE STREET		JOLIET
201 STATE STREET		JOLIET
111 EAST CENTRAL AVENUE		JOLIET
1209 SOUTH WHITE AVENUE		RED LODGE
1209 SOUTH WHITE AVENUE		RED LODGE
1209 SOUTH WHITE AVENUE		RED LODGE
1209 SOUTH WHITE AVENUE		RED LODGE
1209 SOUTH WHITE AVENUE		RED LODGE
30 MONAHAN ROAD		JOLIET
30 MONAHAN ROAD		JOLIET
30 MONAHAN ROAD		JOLIET
BELFRY CEMETERY		BELFRY
22 CARBON AVENUE		BELFRY
4046 HWY 310	4046 Hwy 310	ROCKVALE
CEMETERY ROAD	Cemetery Rd	BRIDGER
6 MONAHAN ROAD	6 Monahan Rd	JOLIET
652 CLEAR CREEK ROAD	652 Clear Creek Rd	ROBERTS
FAIRGROUNDS		RED LODGE
FAIRGROUNDS		RED LODGE
FAIRGROUNDS		RED LODGE
FAIRGROUNDS		RED LODGE
FAIRGROUNDS		RED LODGE
FAIRGROUNDS		RED LODGE
FAIRGROUNDS		RED LODGE
128 SOUTH MAIN STREET		JOLIET
100 AIRPORT ROAD		RED LODGE
10 OAKES AVENUE S		RED LODGE
SW1/4 OF SECTION 14, TOWNSHIP 4 S, RANGE 22 E		JOLIET
104 TOWER LANE		RED LODGE
LATITUDE 45*, 32',15.9" N, LONGITUDE 108*,38',27.4" W		BILLINGS
784 SHANE RIDGE ROAD		RED LODGE
1209 SOUTH WHITE AVENUE		RED LODGE
BELFRY CEMETERY		BELFRY

CEMETERY ROAD		BRIDGER
CEMETERY ROAD		BRIDGER
201 STATE STREET		JOLIET
1 S Oaks Ave		Red Lodge

Division	Period Start	Appraised Value Date	Appraised Value	Builders Risk
	1/1/2023		0.00	0.00
County Courts	1/1/2023	9/20/2022	3,270,900.00	0.00
County Courts	1/1/2023	9/20/2022	1,817,000.00	0.00
Courthouse / Admin Services	1/1/2023	6/1/2013	0.00	0.00
Law Enforcement	1/1/2023	6/1/2013	0.00	0.00
Courthouse / Admin Services	1/1/2023	6/1/2013	0.00	0.00
Law Enforcement	1/1/2023	9/20/2022	330,700.00	0.00
Public Works	1/1/2023	9/20/2022	472,900.00	0.00
Public Works	1/1/2023	9/20/2022	168,200.00	0.00
Public Works	1/1/2023	9/20/2022	9,900.00	0.00
Public Works	1/1/2023	9/20/2022	12,300.00	0.00
Public Works	1/1/2023	9/20/2022	21,200.00	0.00
Public Works	1/1/2023	9/20/2022	75,300.00	0.00
Public Works	1/1/2023	9/20/2022	913,200.00	0.00
Public Works	1/1/2023	9/20/2022	173,600.00	0.00
Public Works	1/1/2023	9/20/2022	140,000.00	0.00
Public Works	1/1/2023	9/20/2022	107,300.00	0.00
Public Works	1/1/2023	9/20/2022	662,500.00	0.00
Public Works	1/1/2023	9/20/2022	202,000.00	0.00
Public Works	1/1/2023	9/20/2022	387,200.00	0.00
Public Works	1/1/2023	9/20/2022	49,500.00	0.00
Public Works	1/1/2023	9/20/2022	74,200.00	0.00
Weed	1/1/2023	9/20/2022	473,700.00	0.00
Weed	1/1/2023	9/20/2022	16,200.00	0.00
Weed	1/1/2023	9/20/2022	12,800.00	0.00
Parks & Cemeteries	1/1/2023	9/20/2022	39,700.00	0.00
Parks & Cemeteries	1/1/2023	6/1/2013	0.00	0.00
Parks & Cemeteries	1/1/2023	9/20/2022	114,000.00	0.00
Parks & Cemeteries	1/1/2023	6/1/2013	0.00	0.00
Parks & Cemeteries	1/1/2023	9/20/2022	68,000.00	0.00
Parks & Cemeteries	1/1/2023	9/20/2022	37,300.00	0.00
Fairgrounds / Events Center	1/1/2023	9/20/2022	897,400.00	0.00
Fairgrounds / Events Center	1/1/2023	9/20/2022	578,700.00	0.00
Fairgrounds / Events Center	1/1/2023	9/20/2022	225,700.00	0.00
Fairgrounds / Events Center	1/1/2023	9/20/2022	263,700.00	0.00
Fairgrounds / Events Center	1/1/2023	9/20/2022	84,600.00	0.00
Fairgrounds / Events Center	1/1/2023	9/20/2022	130,000.00	0.00
Fairgrounds / Events Center	1/1/2023	9/20/2022	36,400.00	0.00
Education Resource Services	1/1/2023	9/20/2022	890,800.00	0.00
Airport	1/1/2023	9/20/2022	84,400.00	0.00
	1/1/2023	9/20/2022	1,081,500.00	0.00
	1/1/2023		0.00	0.00
Disaster & Emergency Services	1/1/2023		0.00	0.00
Law Enforcement	1/1/2023		0.00	0.00
Law Enforcement	1/1/2023		0.00	0.00
Public Works	1/1/2023	9/20/2022	14,800.00	0.00
Community Service	1/1/2023	9/20/2022	12,400.00	0.00

	1/1/2023	9/20/2022	131,100.00	0.00
	1/1/2023	9/20/2022	29,300.00	0.00
Public Works	1/1/2023	9/20/2022	51,400.00	0.00
Courthouse / Admin Services	1/1/2023			0.00
			14,161,800.00	0.00

Contents	Inland Marine	Other	Replacement Value	Stated Value	Total Covered Value
0.00	0.00	0.00	0.00	0.00	0.00
420,000.00	0.00	0.00	3,270,900.00	0.00	3,690,900.00
328,000.00	0.00	0.00	1,817,000.00	0.00	2,145,000.00
95,000.00	0.00	0.00	264,057.00	0.00	359,057.00
50,000.00	0.00	0.00	128,129.00	0.00	178,129.00
174,451.00	0.00	0.00	63,804.00	0.00	238,255.00
14,700.00	0.00	0.00	330,700.00	0.00	345,400.00
75,000.00	0.00	0.00	472,900.00	0.00	547,900.00
32,311.00	0.00	0.00	168,200.00	0.00	200,511.00
0.00	0.00	0.00	9,900.00	0.00	9,900.00
0.00	0.00	0.00	12,300.00	0.00	12,300.00
0.00	0.00	0.00	21,200.00	0.00	21,200.00
0.00	0.00	0.00	75,300.00	0.00	75,300.00
160,000.00	0.00	40,000.00	913,200.00	0.00	1,113,200.00
25,000.00	0.00	0.00	173,600.00	0.00	198,600.00
20,000.00	0.00	0.00	140,000.00	0.00	160,000.00
11,000.00	0.00	0.00	107,300.00	0.00	118,300.00
343,000.00	0.00	0.00	662,500.00	0.00	1,005,500.00
38,769.00	0.00	0.00	202,000.00	0.00	240,769.00
17,000.00	0.00	0.00	387,200.00	0.00	404,200.00
15,000.00	0.00	0.00	49,500.00	0.00	64,500.00
0.00	0.00	0.00	74,200.00	0.00	74,200.00
63,500.00	0.00	0.00	473,700.00	0.00	537,200.00
0.00	0.00	0.00	16,200.00	0.00	16,200.00
0.00	0.00	0.00	12,800.00	0.00	12,800.00
0.00	0.00	0.00	39,700.00	0.00	39,700.00
0.00	0.00	0.00	20,786.00	0.00	20,786.00
17,700.00	0.00	0.00	114,000.00	0.00	131,700.00
0.00	0.00	0.00	20,908.00	0.00	20,908.00
0.00	0.00	0.00	68,000.00	0.00	68,000.00
0.00	0.00	0.00	37,300.00	0.00	37,300.00
21,000.00	0.00	0.00	897,400.00	0.00	918,400.00
20,000.00	0.00	0.00	578,700.00	0.00	598,700.00
0.00	0.00	0.00	225,700.00	0.00	225,700.00
0.00	0.00	0.00	263,700.00	0.00	263,700.00
0.00	0.00	0.00	84,600.00	0.00	84,600.00
0.00	0.00	0.00	130,000.00	0.00	130,000.00
0.00	0.00	0.00	36,400.00	0.00	36,400.00
0.00	0.00	0.00	890,800.00	0.00	890,800.00
0.00	0.00	0.00	84,400.00	0.00	84,400.00
175,000.00	0.00	0.00	1,081,500.00	0.00	1,256,500.00
0.00	0.00	0.00	0.00	0.00	0.00
0.00	0.00	0.00	216,240.00	0.00	216,240.00
50,000.00	0.00	0.00	0.00	0.00	50,000.00
50,000.00	0.00	0.00	0.00	0.00	50,000.00
0.00	0.00	0.00	0.00	8,000.00	8,000.00
0.00	0.00	0.00	0.00	0.00	0.00

0.00	0.00	0.00	0.00	0.00	0.00	0.00
0.00	0.00	0.00	0.00	0.00	0.00	0.00
0.00	0.00	0.00	0.00	0.00	0.00	0.00
250,000.00	0.00	0.00	5,180,000.00	0.00	0.00	5,430,000.00
2,466,431.00	0.00	40,000.00	19,816,724.00	8,000.00	0.00	22,331,155.00

Comments

TWO STORY JOISTED MASONRY HISTORIC COUNTY COURTHOUSE FEATURING SOLID BRICK EXTERIO
SINGLE STORY JOISTED MASONRY OFFICE BUILDING FEATURING A LOBBY, ADMINISTRATIVE OFFICES
DID NOT APPRAISE - OUTSIDE OF SCOPE.

DID NOT APPRAISE - OUTSIDE OF SCOPE.

DID NOT APPRAISE - OUTSIDE OF SCOPE.

TWO LEVEL OLD COUNTY JAIL LISTED ON THE NATIONAL REGISTRY OF HISTORICAL PLACES WITHIN H
NONCOMBUSTIBLE ROAD SHOP FEATURING AN OFFICE, MEZZANINE LEVEL, RESTROOMS AND MAINTEN
NONCOMBUSTIBLE ROAD MAINTENANCE GARAGE FEATURING (2) DRIVE IN BAYS.

WOOD FRAME STORAGE SHED.

WOOD FRAME OPEN FRONT SIGN SHED.

RAILROAD CAR RE PURPOSED FOR STORAGE. ASSET HAS BEEN VALUED AS A STANDARD STORAGE B
VALUE INCLUDES: 5,000 GALLON FUEL STORAGE TANK, DISPENSER AND DEF SHED.

SINGLE STORY WOOD FRAME COUNTY ROAD SHOP AND OFFICE BUILDING FEATURING MAINTENANCE
NONCOMBUSTIBLE MAINTENANCE SHOP FEATURING (2) DRIVE IN BAYS.

MIXED CONSTRUCTION ROAD SHOP GARAGE AND WAREHOUSE.

WOOD FRAME GARAGE BUILDING. NOTE: INTERIOR ACCESS WAS NOT GRANTED AT THE TIME OF APP
NONCOMBUSTIBLE COUNTY ROAD SHOP FEATURING AN OFFICE, RESTROOM, SHOWER ROOM, MEZZA/
NONCOMBUSTIBLE OPEN FRONT EQUIPMENT STORAGE QUONSET SHED.

NONCOMBUSTIBLE GARAGE AND MATERIAL - SAND/SALT STORAGE BUILDING.

WOOD FRAME SIGN STORAGE BUILDING.

VALUE INCLUDES: (2) 1,000 GALLON FUEL STORAGE TANKS, (2) DISPENSERS AND ACCESS READER.

NONCOMBUSTIBLE NOXIOUS WEED OFFICE AND STORAGE WAREHOUSE. PROPERTY IN THE OPEN INC
WOOD FRAME CHEMICAL STORAGE BUILDING ATOP CONCRETE WALL INLAY. BUILDING VALUE INCLUD
WOOD FRAME EQUIPMENT STORAGE BUILDING.

JOISTED MASONRY CEMETERY TOOL SHED. PROPERTY IN THE OPEN INCLUDES: SITE FENCING, SIGNA
DID NOT APPRAISE - PER SCOTT MILLER, COMMISSIONER, THE COUNTY NO LONGER WISHES TO INSU
WOOD FRAME CEMETERY MAINTENANCE BUILDING. PROPERTY IN THE OPEN INCLUDES: SITE FENCIN
DID NOT APPRAISE - THIS BUILDING IS NOT ONSITE APPEARS TO HAVE BEEN DEMOLISHED AND OR RE
JOISTED MASONRY CEMETERY TOOL AND MAINTENANCE BUILDING. PROPERTY IN THE OPEN INCLUDE
WOOD FRAME CEMETERY TOOL SHED. PROPERTY IN THE OPEN INCLUDES: SITE FENCING, BENCHES,
NONCOMBUSTIBLE FAIRGROUNDS COMMUNITY BUILDING FEATURING A OPEN GATHERING ROOM, CO
WOOD FRAME ANIMAL SHOW BARN WITH DIRT FLOOR THROUGHOUT.

WOOD FRAME HOG AND SHEEP BARN WITH DIRT FLOOR.

WOOD FRAME EQUINE STABLE WITH ATTACHED LEAN TO.

WOOD FRAME EQUINE STALL SHELTER. VALUE INCLUDES: STALLS.

WOOD FRAME FAIRGROUNDS OFFICE BUILDING - EMERGENCY OPERATIONS CENTER WITH POULTRY

WOOD FRAME FAIRGROUNDS BUILDING WITH OFFICE AND MAINTENANCE AREA.

SINGLE STORY JOISTED MASONRY OFFICE BUILDING FEATURING AN UNFINISHED PARTIAL BASEMENT
WOOD FRAME SNOWPLOW GARAGE.

SINGLE STORY JOISTED MASONRY OFFICE BUILDING FEATURING AN UNFINISHED PARTIAL BASEMENT
DID NOT APPRAISE - VACANT LAND.

DID NOT APPRAISE - OUTSIDE OF SCOPE.

DID NOT APPRAISE - OUTSIDE OF SCOPE.

DID NOT APPRAISE - OUTSIDE OF SCOPE.

WOOD FRAME STORAGE SHED.

MIXED CONSTRUCTION OPEN AIR CEMETERY PAVILION.

WOOD FRAME CEMETERY SHOP. PROPERTY IN THE OPEN INCLUDES: SITE FENCING, OUTHOUSE AND MIXED CONSTRUCTION OPEN AIR PAVILION.

WOOD FRAME SAND SHED WITH CONCRETE BARRIER WALLS.



Carbon County
Carbon County
Carbon County
Carbon County

Client Name:
Report Name:
Description:
Filter:
Group By:
Sort By:
Options:
Run Date:

<i>MACo</i>
<i>Active Building Report 2023-2024</i>
<i>Active Building Report 2023-2024</i>
<i>Inactive Date is empty and Period Start (LocationValue) is between 01/01/2023 and 12/31/2023</i>
<i>Member</i>
<i>Location Number</i>
<i>Group Values is Annually</i>
<i>01/03/2024</i>

MACo

Member	Name	Building Description	Year Built
Carbon County	Offsite - Carbon County		
Carbon County	Courthouse	Courthouse	1898
Carbon County	Courthouse - Admin Offices	Courthouse - Admin Offices	1970
Carbon County	Radio Booster Station	Radio Booster Station	1985
Carbon County	Radio Repeater, South Bridger	Radio Repeater, South Bridger	1972
Carbon County	TV Transmitter Building & Tower	TV Transmitter Building & Tower	1980
Carbon County	Courthouse - Storage/Old Jail	Courthouse - Storage / Old Jail	1920
Carbon County	Bridger Road - Shop #1	Bridger Road - Shop	2000
Carbon County	Bridger Road - Shop #2	Bridger Road - Shop #2	1960
Carbon County	Bridger Road - Storage Shed	Bridger Road - Storage Shed	2000
Carbon County	Bridger Road - Sign Shed	Bridger Road - Sign Shed	2003
Carbon County	Bridger Road - Railroad Car Storage	Bridger Road - Railroad Car Storage	1960
Carbon County	Bridger Road - Fueling Station	Bridger Road - Fueling Station	1990
Carbon County	Joliet Road - Shop & Extension Office	Joliet Road - Shop & Extension Office	2012
Carbon County	Joliet Road - Old Shop	Joliet Road - Old Shop	1965
Carbon County	Joliet Road - Garage & Warehouse	Joliet Road - Garage & Warehouse	1960
Carbon County	Joliet Road - Storage Building	Joliet Road - Storage Building	1960
Carbon County	Road Shop	Road Shop	2010
Carbon County	Road Shop, Quonset	Road Shop, Quonset	1975
Carbon County	Road Garage Storage	Road Garage Storage	1960
Carbon County	Road Sign Storage	Road Sign Storage	1950
Carbon County	Fueling Station	Fueling Station	1990
Carbon County	Weed Control - Office	Weed Control - Office	1998
Carbon County	Weed Control - Tank Storage	Weed Control - Tank Storage	1989
Carbon County	Weed Control - Sprayer Storage	Weed Control - Sprayer Storage	1994
Carbon County	Cemetery Tool Shed	Cemetery Tool Shed	1950
Carbon County	Storage Garage	Storage Garage	1960
Carbon County	Cemetery Tool Shed	Cemetery Tool Shed	1950
Carbon County	Belfry Cemetery Tool Shed	Cemetery Tool Shed	1960
Carbon County	Cemetery Tool Shed	Cemetery Tool Shed	1960
Carbon County	Cemetery Tool Shed	Cemetery Tool Shed	1960
Carbon County	Edgar Gruel Building	Home Economics Building	1980
Carbon County	Animal Show Barn	Animal Show Barn	1980
Carbon County	Hog/Sheep Barn	Hog/ Sheep Barn	1985
Carbon County	Horse Barn	Horse Barn	1985
Carbon County	Horse Stall Cover	Horse Stall Cover	2012
Carbon County	EOC/Poultry Building	EOC/ Poultry Building	2011
Carbon County	Fair Office	Fair Office	1980
Carbon County	Extension Office	Extension Office	1920
Carbon County	Steel Snowplow Garage	Steel Snowplow Garage	2013
Carbon County	Office Building	Office Building	1960
Carbon County	Vacant Land - Tract 1-C 1 COS982	Vacant Land - Parcel No: 1619600	
Carbon County	Radio Repeater - Rock Creek Tower	Radio Repeater - Rock Creek Tower	
Carbon County	Radio Repeater - Greeno Tower	Radio Repeater - Greeno Tower	
Carbon County	Radio Repeater - Shane Ridge	Radio Repeater - Shane Ridge	
Carbon County	Road Shop - Wooden Shed	Red Lodge Road Shop - Wooden Shed	2021
Carbon County	BELFRY - CEMETERY PAVILION	BELFRY - CEMETERY PAVILION	2019

Carbon County	BRIDGER - CEMETERY SHOP	BRIDGER - CEMETERY SHOP	2013
Carbon County	BRIDGER - CEMETERY PAVILION	BRIDGER - CEMETERY PAVILION	2019
Carbon County	SAND SHED	JOLIET ROAD - SAND SHED	2019
Carbon County	New Admin Building	Old Cedarwood Building	1975

Building Export Report

Location Number	Active Date	Not Covered	Inactive Date
CB05- 1			
CB05-001		False	
CB05-002		False	
CB05-003		False	
CB05-005		False	
CB05-007		False	
CB05-008		False	
CB05-015		False	
CB05-016		False	
CB05-017		False	
CB05-018		False	
CB05-019		False	
CB05-020		False	
CB05-021		False	
CB05-022		False	
CB05-023		False	
CB05-024		False	
CB05-025		False	
CB05-026		False	
CB05-027		False	
CB05-028		False	
CB05-029		False	
CB05-030		False	
CB05-031		False	
CB05-032		False	
CB05-033		False	
CB05-034		True	
CB05-035		False	
CB05-036		False	
CB05-037		False	
CB05-038		False	
CB05-039		False	
CB05-040		False	
CB05-041		False	
CB05-042		False	
CB05-043		False	
CB05-044		False	
CB05-045		False	
CB05-046		False	
CB05-047		False	
CB05-049		False	
CB05-050	1/4/2021	True	
CB05-051	2/9/2021	False	
CB05-052	2/9/2021	False	
CB05-053	2/9/2021	False	
CB05-054	5/20/2021	False	
CB05-058	9/20/2022	True	

CB05-059	9/20/2022	True	
CB05-060	9/20/2022	True	
CB05-061	9/20/2022	True	
CB05-062	12/2/2022	False	
51			

Street1	Street2	City
100 NORTH BROADWAY AVENUE		RED LODGE
17 11TH STREET W		RED LODGE
116 RED LODGE MOUNTAIN		RED LODGE
26 WEBBER LANE		BRIDGER
26 WEBBER LANE		BRIDGER
100 NORTH BROADWAY AVENUE		RED LODGE
22 OLD MINE ROAD		BRIDGER
22 OLD MINE ROAD		BRIDGER
22 OLD MINE ROAD		BRIDGER
22 OLD MINE ROAD		BRIDGER
22 OLD MINE ROAD		BRIDGER
22 OLD MINE ROAD		BRIDGER
201 STATE STREET		JOLIET
201 STATE STREET		JOLIET
201 STATE STREET		JOLIET
111 EAST CENTRAL AVENUE		JOLIET
1209 SOUTH WHITE AVENUE		RED LODGE
1209 SOUTH WHITE AVENUE		RED LODGE
1209 SOUTH WHITE AVENUE		RED LODGE
1209 SOUTH WHITE AVENUE		RED LODGE
1209 SOUTH WHITE AVENUE		RED LODGE
30 MONAHAN ROAD		JOLIET
30 MONAHAN ROAD		JOLIET
30 MONAHAN ROAD		JOLIET
BELFRY CEMETERY		BELFRY
22 CARBON AVENUE		BELFRY
4046 HWY 310	4046 Hwy 310	ROCKVALE
CEMETERY ROAD	Cemetery Rd	BRIDGER
6 MONAHAN ROAD	6 Monahan Rd	JOLIET
652 CLEAR CREEK ROAD	652 Clear Creek Rd	ROBERTS
FAIRGROUNDS		RED LODGE
FAIRGROUNDS		RED LODGE
FAIRGROUNDS		RED LODGE
FAIRGROUNDS		RED LODGE
FAIRGROUNDS		RED LODGE
FAIRGROUNDS		RED LODGE
FAIRGROUNDS		RED LODGE
128 SOUTH MAIN STREET		JOLIET
100 AIRPORT ROAD		RED LODGE
10 OAKES AVENUE S		RED LODGE
SW1/4 OF SECTION 14, TOWNSHIP 4 S, RANGE 22 E		JOLIET
104 TOWER LANE		RED LODGE
LATITUDE 45*, 32',15.9" N, LONGITUDE 108*,38',27.4" W		BILLINGS
784 SHANE RIDGE ROAD		RED LODGE
1209 SOUTH WHITE AVENUE		RED LODGE
BELFRY CEMETERY		BELFRY

CEMETERY ROAD		BRIDGER
CEMETERY ROAD		BRIDGER
201 STATE STREET		JOLIET
1 S Oaks Ave		Red Lodge

Division	Period Start	Appraised Value Date	Appraised Value	Builders Risk
	1/1/2024		0.00	0.00
County Courts	1/1/2024	9/20/2022	3,270,900.00	0.00
County Courts	1/1/2024	9/20/2022	1,817,000.00	0.00
Courthouse / Admin Services	1/1/2024	6/1/2013	0.00	0.00
Law Enforcement	1/1/2024	6/1/2013	0.00	0.00
Courthouse / Admin Services	1/1/2024	6/1/2013	0.00	0.00
Law Enforcement	1/1/2024	9/20/2022	330,700.00	0.00
Public Works	1/1/2024	9/20/2022	472,900.00	0.00
Public Works	1/1/2024	9/20/2022	168,200.00	0.00
Public Works	1/1/2024	9/20/2022	9,900.00	0.00
Public Works	1/1/2024	9/20/2022	12,300.00	0.00
Public Works	1/1/2024	9/20/2022	21,200.00	0.00
Public Works	1/1/2024	9/20/2022	75,300.00	0.00
Public Works	1/1/2024	9/20/2022	913,200.00	0.00
Public Works	1/1/2024	9/20/2022	173,600.00	0.00
Public Works	1/1/2024	9/20/2022	140,000.00	0.00
Public Works	1/1/2024	9/20/2022	107,300.00	0.00
Public Works	1/1/2024	9/20/2022	662,500.00	0.00
Public Works	1/1/2024	9/20/2022	202,000.00	0.00
Public Works	1/1/2024	9/20/2022	387,200.00	0.00
Public Works	1/1/2024	9/20/2022	49,500.00	0.00
Public Works	1/1/2024	9/20/2022	74,200.00	0.00
Weed	1/1/2024	9/20/2022	473,700.00	0.00
Weed	1/1/2024	9/20/2022	16,200.00	0.00
Weed	1/1/2024	9/20/2022	12,800.00	0.00
Parks & Cemeteries	1/1/2024	9/20/2022	39,700.00	0.00
Parks & Cemeteries	1/1/2024	6/1/2013	0.00	0.00
Parks & Cemeteries	1/1/2024	9/20/2022	114,000.00	0.00
Parks & Cemeteries	1/1/2024	6/1/2013	0.00	0.00
Parks & Cemeteries	1/1/2024	9/20/2022	68,000.00	0.00
Parks & Cemeteries	1/1/2024	9/20/2022	37,300.00	0.00
Fairgrounds / Events Center	1/1/2024	9/20/2022	897,400.00	0.00
Fairgrounds / Events Center	1/1/2024	9/20/2022	578,700.00	0.00
Fairgrounds / Events Center	1/1/2024	9/20/2022	225,700.00	0.00
Fairgrounds / Events Center	1/1/2024	9/20/2022	263,700.00	0.00
Fairgrounds / Events Center	1/1/2024	9/20/2022	84,600.00	0.00
Fairgrounds / Events Center	1/1/2024	9/20/2022	130,000.00	0.00
Fairgrounds / Events Center	1/1/2024	9/20/2022	36,400.00	0.00
Education Resource Services	1/1/2024	9/20/2022	890,800.00	0.00
Airport	1/1/2024	9/20/2022	84,400.00	0.00
	1/1/2024	9/20/2022	1,081,500.00	0.00
	1/1/2024		0.00	0.00
Disaster & Emergency Services	1/1/2024		0.00	0.00
Law Enforcement	1/1/2024		0.00	0.00
Law Enforcement	1/1/2024		0.00	0.00
Public Works	1/1/2024	9/20/2022	14,800.00	0.00
Community Service	1/1/2024	9/20/2022	12,400.00	0.00

	1/1/2024	9/20/2022	131,100.00	0.00
	1/1/2024	9/20/2022	29,300.00	0.00
Public Works	1/1/2024	9/20/2022	51,400.00	0.00
Courthouse / Admin Services	1/1/2024			0.00
			14,161,800.00	0.00

Contents	Inland Marine	Other	Replacement Value	Stated Value	Total Covered Value
0.00	0.00	0.00	0.00	0.00	0.00
420,000.00	0.00	0.00	3,437,715.90	0.00	3,857,715.90
328,000.00	0.00	0.00	1,909,667.00	0.00	2,237,667.00
95,000.00	0.00	0.00	277,523.91	0.00	372,523.91
50,000.00	0.00	0.00	134,663.58	0.00	184,663.58
174,451.00	0.00	0.00	67,058.00	0.00	241,509.00
14,700.00	0.00	0.00	347,565.70	0.00	362,265.70
75,000.00	0.00	0.00	497,017.90	0.00	572,017.90
32,311.00	0.00	0.00	176,778.20	0.00	209,089.20
0.00	0.00	0.00	10,404.90	0.00	10,404.90
0.00	0.00	0.00	12,927.30	0.00	12,927.30
0.00	0.00	0.00	22,281.20	0.00	22,281.20
0.00	0.00	0.00	79,140.30	0.00	79,140.30
160,000.00	0.00	40,000.00	959,773.20	0.00	1,159,773.20
25,000.00	0.00	0.00	182,453.60	0.00	207,453.60
20,000.00	0.00	0.00	147,140.00	0.00	167,140.00
11,000.00	0.00	0.00	112,772.30	0.00	123,772.30
343,000.00	0.00	0.00	696,287.50	0.00	1,039,287.50
38,769.00	0.00	0.00	212,302.00	0.00	251,071.00
17,000.00	0.00	0.00	406,947.20	0.00	423,947.20
15,000.00	0.00	0.00	52,024.50	0.00	67,024.50
0.00	0.00	0.00	77,984.20	0.00	77,984.20
63,500.00	0.00	0.00	497,858.70	0.00	561,358.70
0.00	0.00	0.00	17,026.20	0.00	17,026.20
0.00	0.00	0.00	13,452.80	0.00	13,452.80
0.00	0.00	0.00	41,724.70	0.00	41,724.70
0.00	0.00	0.00	21,846.09	0.00	21,846.09
17,700.00	0.00	0.00	119,814.00	0.00	137,514.00
0.00	0.00	0.00	21,974.31	0.00	21,974.31
0.00	0.00	0.00	71,468.00	0.00	71,468.00
0.00	0.00	0.00	39,202.30	0.00	39,202.30
21,000.00	0.00	0.00	943,167.40	0.00	964,167.40
20,000.00	0.00	0.00	608,213.70	0.00	628,213.70
0.00	0.00	0.00	237,210.70	0.00	237,210.70
0.00	0.00	0.00	277,148.70	0.00	277,148.70
0.00	0.00	0.00	88,914.60	0.00	88,914.60
0.00	0.00	0.00	136,630.00	0.00	136,630.00
0.00	0.00	0.00	38,256.40	0.00	38,256.40
0.00	0.00	0.00	936,230.80	0.00	936,230.80
0.00	0.00	0.00	88,704.40	0.00	88,704.40
175,000.00	0.00	0.00	1,136,656.50	0.00	1,311,656.50
0.00	0.00	0.00	0.00	0.00	0.00
0.00	0.00	0.00	227,268.24	0.00	227,268.24
50,000.00	0.00	0.00	0.00	0.00	50,000.00
50,000.00	0.00	0.00	0.00	0.00	50,000.00
0.00	0.00	0.00	0.00	8,000.00	8,000.00
0.00	0.00	0.00	0.00	0.00	0.00

0.00	0.00	0.00	0.00	0.00	0.00	0.00
0.00	0.00	0.00	0.00	0.00	0.00	0.00
0.00	0.00	0.00	0.00	0.00	0.00	0.00
250,000.00	0.00	0.00	5,444,180.00	0.00		5,694,180.00
2,466,431.00	0.00	40,000.00	20,827,376.93	8,000.00		23,341,807.93

Comments

TWO STORY JOISTED MASONRY HISTORIC COUNTY COURTHOUSE FEATURING SOLID BRICK EXTERIO
SINGLE STORY JOISTED MASONRY OFFICE BUILDING FEATURING A LOBBY, ADMINISTRATIVE OFFICES
DID NOT APPRAISE - OUTSIDE OF SCOPE.

DID NOT APPRAISE - OUTSIDE OF SCOPE.

DID NOT APPRAISE - OUTSIDE OF SCOPE.

TWO LEVEL OLD COUNTY JAIL LISTED ON THE NATIONAL REGISTRY OF HISTORICAL PLACES WITHIN H
NONCOMBUSTIBLE ROAD SHOP FEATURING AN OFFICE, MEZZANINE LEVEL, RESTROOMS AND MAINTEN
NONCOMBUSTIBLE ROAD MAINTENANCE GARAGE FEATURING (2) DRIVE IN BAYS.

WOOD FRAME STORAGE SHED.

WOOD FRAME OPEN FRONT SIGN SHED.

RAILROAD CAR RE PURPOSED FOR STORAGE. ASSET HAS BEEN VALUED AS A STANDARD STORAGE B
VALUE INCLUDES: 5,000 GALLON FUEL STORAGE TANK, DISPENSER AND DEF SHED.

SINGLE STORY WOOD FRAME COUNTY ROAD SHOP AND OFFICE BUILDING FEATURING MAINTENANCE
NONCOMBUSTIBLE MAINTENANCE SHOP FEATURING (2) DRIVE IN BAYS.

MIXED CONSTRUCTION ROAD SHOP GARAGE AND WAREHOUSE.

WOOD FRAME GARAGE BUILDING. NOTE: INTERIOR ACCESS WAS NOT GRANTED AT THE TIME OF APP
NONCOMBUSTIBLE COUNTY ROAD SHOP FEATURING AN OFFICE, RESTROOM, SHOWER ROOM, MEZZA/
NONCOMBUSTIBLE OPEN FRONT EQUIPMENT STORAGE QUONSET SHED.

NONCOMBUSTIBLE GARAGE AND MATERIAL - SAND/SALT STORAGE BUILDING.

WOOD FRAME SIGN STORAGE BUILDING.

VALUE INCLUDES: (2) 1,000 GALLON FUEL STORAGE TANKS, (2) DISPENSERS AND ACCESS READER.

NONCOMBUSTIBLE NOXIOUS WEED OFFICE AND STORAGE WAREHOUSE. PROPERTY IN THE OPEN INC
WOOD FRAME CHEMICAL STORAGE BUILDING ATOP CONCRETE WALL INLAY. BUILDING VALUE INCLUD
WOOD FRAME EQUIPMENT STORAGE BUILDING.

JOISTED MASONRY CEMETERY TOOL SHED. PROPERTY IN THE OPEN INCLUDES: SITE FENCING, SIGNA
DID NOT APPRAISE - PER SCOTT MILLER, COMMISSIONER, THE COUNTY NO LONGER WISHES TO INSU
WOOD FRAME CEMETERY MAINTENANCE BUILDING. PROPERTY IN THE OPEN INCLUDES: SITE FENCIN
DID NOT APPRAISE - THIS BUILDING IS NOT ONSITE APPEARS TO HAVE BEEN DEMOLISHED AND OR RE
JOISTED MASONRY CEMETERY TOOL AND MAINTENANCE BUILDING. PROPERTY IN THE OPEN INCLUDE
WOOD FRAME CEMETERY TOOL SHED. PROPERTY IN THE OPEN INCLUDES: SITE FENCING, BENCHES,
NONCOMBUSTIBLE FAIRGROUNDS COMMUNITY BUILDING FEATURING A OPEN GATHERING ROOM, CO
WOOD FRAME ANIMAL SHOW BARN WITH DIRT FLOOR THROUGHOUT.

WOOD FRAME HOG AND SHEEP BARN WITH DIRT FLOOR.

WOOD FRAME EQUINE STABLE WITH ATTACHED LEAN TO.

WOOD FRAME EQUINE STALL SHELTER. VALUE INCLUDES: STALLS.

WOOD FRAME FAIRGROUNDS OFFICE BUILDING - EMERGENCY OPERATIONS CENTER WITH POULTRY

WOOD FRAME FAIRGROUNDS BUILDING WITH OFFICE AND MAINTENANCE AREA.

SINGLE STORY JOISTED MASONRY OFFICE BUILDING FEATURING AN UNFINISHED PARTIAL BASEMENT
WOOD FRAME SNOWPLOW GARAGE.

SINGLE STORY JOISTED MASONRY OFFICE BUILDING FEATURING AN UNFINISHED PARTIAL BASEMENT
DID NOT APPRAISE - VACANT LAND.

DID NOT APPRAISE - OUTSIDE OF SCOPE.

DID NOT APPRAISE - OUTSIDE OF SCOPE.

DID NOT APPRAISE - OUTSIDE OF SCOPE.

WOOD FRAME STORAGE SHED.

MIXED CONSTRUCTION OPEN AIR CEMETERY PAVILION.

WOOD FRAME CEMETERY SHOP. PROPERTY IN THE OPEN INCLUDES: SITE FENCING, OUTHOUSE AND MIXED CONSTRUCTION OPEN AIR PAVILION.

WOOD FRAME SAND SHED WITH CONCRETE BARRIER WALLS.

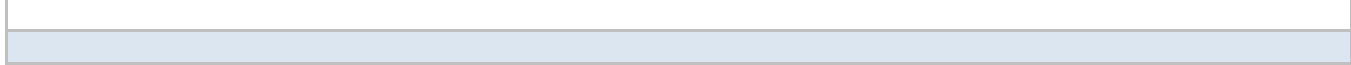

Carbon County
Carbon County
Carbon County
Carbon County

Client Name:
Report Name:
Description:
Filter:
Group By:
Sort By:
Options:
Run Date:

<i>MACo</i>
<i>^Active Building Report</i>
<i>Active Building Report for the 2024-2025 policy year</i>
<i>Period Start (LocationValue) is between 01/01/2024 and 12/31/2024 and Inactive Date is empty</i>
<i>Member</i>
<i>Location Number</i>
<i>Group Values is Annually</i>
<i>01/03/2024</i>

MACo

Equ

	Member ID	Equipment Number	Mobile Equipment Type
Member ID: Carbon County			
	Carbon County	CB05-0036	Heavy Equipment
	Carbon County	CB05-0039	Heavy Equipment
	Carbon County	CB05-0040	Heavy Equipment
	Carbon County	CB05-0041	Heavy Equipment
	Carbon County	CB05-0045	Heavy Equipment
	Carbon County	CB05-0046	Heavy Equipment
	Carbon County	CB05-0072	Heavy Equipment
	Carbon County	CB05-0048	Heavy Equipment
	Carbon County	CB05-0050	Heavy Equipment
	Carbon County	CB05-0052	Heavy Equipment
	Carbon County	CB05-0053	Heavy Equipment
	Carbon County	CB05-0055	Heavy Equipment
	Carbon County	CB05-0057	Heavy Equipment
	Carbon County	CB05-0058	Heavy Equipment
	Carbon County	CB05-0059	Heavy Equipment
	Carbon County	CB05-0060	Heavy Equipment
	Carbon County	CB05-0061	Heavy Equipment
	Carbon County	CB05-0062	Heavy Equipment
	Carbon County	CB05-0063	Heavy Equipment
	Carbon County	CB05-0065	Heavy Equipment
	Carbon County	CB05-0069	Heavy Equipment
	Carbon County	CB05-0071	Heavy Equipment
	Carbon County	CB05-0087	Other
	Carbon County	CB05-0088	Other
	Carbon County	CB05-0089	Other
	Carbon County	CB05-0092	Heavy Equipment
	Carbon County	CB05-0093	Heavy Equipment
	Carbon County	CB05-0094	Heavy Equipment
	Carbon County	CB05-0095	Heavy Equipment
	Carbon County	CB05-0096	Heavy Equipment
	Carbon County	CB05-0097	Heavy Equipment
	Carbon County	CB05-0099	Other
	Carbon County	CB05-0100	Heavy Equipment
	Carbon County	CB05-0101	Attachment
	Carbon County	CB05-0102	Heavy Equipment
	Carbon County	CB05-0103	Heavy Equipment
	Carbon County	CB05-0104	Other
	Carbon County	CB05-0106	Heavy Equipment
	Carbon County	CB05-0107	Attachment
	Carbon County	CB05-0108	Attachment
	Carbon County	CB05-0109	Attachment
	Carbon County	CB05-0110	Heavy Equipment
	Carbon County	CB05-0111	Heavy Equipment
	Carbon County	CB05-0112	Attachment
	Carbon County	CB05-0113	Heavy Equipment
	Carbon County	CB05-0114	Other

	Carbon County	CB05-0115	Heavy Equipment
	Carbon County	CB05-0116	Heavy Equipment
	Carbon County	CB05-0117	Heavy Equipment
Totals for Carbon County - 49 Mobile Equipment			
Grand Totals - 49 Mobile Equipment			

Equipment Export Report

Year	Make	Model / Description
2001	GEHL	SKID STEER LOADER
1994	HYSTAR	FORK LIFT
2006	GEHL	SKIDSTEER LOADER
	FIAT ALLIS	SCRAPER
1983	CATERPILLAR	950B LOADER
1978	CATERPILLAR	DOZER
	JOHN DEERE	7400 TIGER MOWER
1999	CATERPILLAR	950G LOADER
2006	CATERPILLAR	308CCR EXCAVATOR
1989	CASE	W14E LOADER
2001	JOHN DEERE	TC62H LOADER
2014	JOHN DEERE	872G MOTOR GRADER
2013	JOHN DEERE	772G MOTOR GRADER
2012	JOHN DEERE	872G GRADER
2014	CATERPILLAR	160M2 AWD MOTOR GRADER
2015	CATERPILLAR	160M3 AWD
2016	JOHN DEERE	872G MOTOR GRADER
2018	JOHN DEERE	872G MOTOR GRADER
2017	CATERPILLAR	160M3 AWD MOTOR GRADER
1983	CATERPILLAR	D8K BULLDOZER
2005	JOHN DEERE	317
	CATERPILLAR	928F LOADER
2018	JOHN DEERE	872G WING ATTACHMENT
2018	JOHN DEERE	872G VFLOW ATTACHMENT
2006		GEHL LOADER ATTACHMENTS: PLOW, BUCKET, FORKS, AUGER, TAMPER
1998	JOHN DEERE	544H WHEEL LOADER
1998	JOHN DEERE	544H LOADER
	CASE	CX80 EXCAVATOR
2019	JOHN DEERE	872G MOTOR GRADER
2012	CASE	590 SUPER H
1983	CLARK	175B FRONT END LOADER GREEN
2020	BAD BOY	RIDING LAWN MOWER
2011	JOHN DEERE	6115D TRACTOR
	FINALE PASS	11 MOUNTED RIPPER/COMPACTOR PRESSURE CONTROL VALVE
2019	CATERPILLAR	160M3 MOTOR GRADER
1997	CATERPILLAR	D6R-XL BULLDOZER
	VERMEER	WOOD CHIPPER - BC1000XL
2016	JOHN DEERE	872G MOTOR GRADER
2020	BALDERSON	RETRIEVER W/GRADER FRONT MOUNT
2020	BALDERSON	RETRIEVER W/GRADER FRONT MOUNT
	MOUNT	300 GAL TRUCK MOUNTED SPRAYER
2007	BOBCAT	SKIDSTEER
2007	BOBCAT	SKIDSTEER
2022	OTHER	STEEL DRUM ROLLER - 9FT
2019	JOHN DEERE	210 GLC EXCAVATOR + 2 ATTACHMENTS
2022	HOMEMADE	STEEL DRUM STATIC ROLLER - TOW TYPE

2023	JOHN DEERE	872G MOTOR GRADER w/ATTACHMENTS
2022	JOHN DEERE	872G MOTOR GRADER
2004	CATERPILLAR	M318C WHEELED EXCAVATOR

Serial Number	Active Date	Inactive Date	Liability Only	Ownership Type
3635 (OR 224001074)			False	Owned
D177G09325R			False	Owned
GHL06640E00606305			False	Owned
13500267	2/28/2018		False	Owned
227808 (OR 22Z00808)	2/28/2018		False	Owned
4X3149 (OR 43149)	2/28/2018		False	Owned
RW7400H004288	2/3/2018		True	Owned
3JW00929			False	Owned
CAT0308CKKCX00494	2/2/2018		False	Owned
JAK0018118			False	Owned
DW7C62H579434 (OR DWT...)			False	Owned
1DW872GPCEF658759	2/2/2018		False	Owned
1DW772GXHDE651596	2/2/2018		False	Owned
1DW872GXBE641991			False	Owned
R9T00349	2/2/2018		False	Owned
N9k00127	2/2/2018		False	Owned
1DW872GXJGF678101	2/2/2018		False	Owned
1DW872GPEJF691642	11/27/2018		False	Owned
N9T00264	12/11/2017		False	
77V18673	2/9/2018		False	Owned
T00317A110546	2/3/2018		False	Owned
8AK00427	2/3/2018		True	Owned
MISC-13	11/27/2018		False	Owned
MISC-14	11/27/2018		False	Owned
MISC-230	2/10/2018		False	Owned
DW544HX564841	6/20/2019		False	Owned
DW544HX564840	6/21/2019		False	Owned
DAC881337	9/10/2019		False	Owned
1DW872GPLKF702508	10/24/2019		False	Owned
JJGN59SNKDC591093	2/15/2020		False	Owned
427C824	2/15/2020		False	Owned
BZT60FR73002200108	6/11/2020		False	Owned
1P06115DHBH021236	8/11/2020		False	Owned
PASS 11	9/29/2020		False	Owned
CAT0168MAN9K01120	10/20/2020		False	Owned
5LN00793	10/27/2020		False	Owned
3380	4/1/2021		False	Owned
1DW872GPPGF677544/ X892192	12/3/2021		False	Leased
BQFM1908052/GM1908609	3/15/2021		False	Owned
BQFM2007077/GM2003629	10/1/2020		False	Owned
	1/20/2021		False	Owned
527713350	3/15/2022		False	Owned
527713352	3/15/2022		False	
441	6/2/2022		False	Owned
1FF210GXHKF527311	8/8/2022		False	Owned
	11/16/2022		False	Owned

1DW872GPAPF716608	12/1/2022		False	Owned
IDW872GPVNF713915	4/5/2022		False	Owned
2YF02630198998 / BCZ00778	2/9/2023		False	Owned

Equipment Dept	Misc Dept	Misc ID
Road / Surveyor	218-2	315
Road / Surveyor	218-3	325
Road / Surveyor	218-3	314
Road / Surveyor	218-2	407
Road / Surveyor	218-2	408
Road / Surveyor	218-2	410
Road / Surveyor	218-1	312
Road / Surveyor	218-3	417
Road / Surveyor	218-3	421
Road / Surveyor	218-3	413
Road / Surveyor	218-1	419
Road / Surveyor	218-1	430
Road / Surveyor	218-2	429
Road / Surveyor	218-3	428
Road / Surveyor	218-3	431
Road / Surveyor	218-2	432
Road / Surveyor	218-1	422
Road / Surveyor	218-2	425
	218-3	424
Road / Surveyor	218-3 - Red Lodge	409
Road / Surveyor	218-1	316
Road / Surveyor	218-3	433
Road / Surveyor	218-2	
Road / Surveyor	218-2	
Road / Surveyor	218-3	314
Road / Surveyor	218-3	439
Road / Surveyor	218-3	438
Road / Surveyor	218-1	423
Road / Surveyor	218-1	426
Road / Surveyor	218-2	427
Road / Surveyor	437	218-2
Weed Control	251	
Road / Surveyor	218-3	1236
Road / Surveyor	218-2	331
Road / Surveyor	218-3	420A
Road / Surveyor		218-2
Road / Surveyor	218-3	680
Road / Surveyor		
Road / Surveyor	218-1	333
Road / Surveyor	218-2	334
Weed Control		
Bridge	218-1	603
Bridge		
Road / Surveyor	218-3	441
Road / Surveyor	218-ALL	412
Road / Surveyor	218-3	338

Road / Surveyor	218-1	442
Road / Surveyor	218-2	440
Road / Surveyor	218-2	443

Misc Info	Value
YELLOW, TRACK-TYPE LOADER, GENERAL PURPOSE BUCKET	15,000.00
	15,000.00
	17,000.00
	20,000.00
1983 Caterpillar 950B Loader	30,000.00
YELLOW	40,000.00
	0.00
	50,000.00
	65,000.00
1989LOADERCASEW14E	84,000.00
	125,000.00
WITH H&K EQUIPMENT 2100 12 WING	229,000.00
	276,760.00
2012 GRADER JOHN DEERE 872G	285,895.00
	336,178.00
	336,268.00
	340,220.00
	343,045.00
	350,346.00
Dozer Tractor Crawler 310 HP Semi U Blade	90,000.00
INCLUDES 4 ATTACHMENTS	10,000.00
MILITARY SURPLUS	0.00
	13,978.00
	6,865.00
	5,675.00
STATE SURPLUS	79,900.00
STATE SURPLUS	104,900.00
INCLUDES TWO BUCKETS & HOE	58,000.00
INCLUDES RIPPER, WING, VFLOW	385,800.00
	40,000.00
	15,500.00
	5,199.00
	31,000.00
ATTACHED TO 432	15,000.00
	319,000.00
	100,000.00
	10,000.00
Loss Payee: RDO Equipment	300,000.00
Attached to JD Graders	17,000.00
Attached to JD Graders	17,000.00
Attached to 405 Pickup	8,375.00
	16,100.00
	16,100.00
Built by Red Lodge Road Dept	6,500.00
Excavator W/Attachments	333,040.00
	6,500.00

2022 FQ snow wing #WG123261 & 2022 HK FV-12 47" TAL #34067	474,500.00
	432,000.00
MILITARY SUPLUS	100,000.00
	5,976,644.00
	5,976,644.00

Misc Info

YELLOW, TRACK-TYPE LOADER, GENERAL PURPOSE BUCKET

1983 Caterpillar 950B Loader
YELLOW

1989LOADERCASEW14E

WITH H&K EQUIPMENT 2100 12 WING

2012 GRADER JOHN DEERE 872G

Dozer Tractor Crawler 310 HP Semi U Blade
INCLUDES 4 ATTACHMENTS
MILITARY SURPLUS

STATE SURPLUS
STATE SURPLUS
INCLUDES TWO BUCKETS & HOE
INCLUDES RIPPER, WING, VPLOW

ATTACHED TO 432

Loss Payee: RDO Equipment
Attached to JD Graders
Attached to JD Graders
Attached to 405 Pickup

Built by Red Lodge Road Dept
Excavator W/Attachments

2022 FQ snow wing #WG123261 & 2022 HK FV-12 47" TAL #34067

MILITARY SUPLUS

Client Name:	<i>MACo</i>
Report Name:	<i>^Active Mobile Equipment - All Fields</i>
Description:	<i>Active Mobile Equipment</i>
Filter:	<i>Inactive Date is empty</i>
Group By:	<i>Member ID</i>
Sort By:	<i>No Sorts</i>
Options:	<i>None</i>
Run Date:	<i>01/03/2024</i>

MACo

Member	Vehicle Number	Vehicle Type	Year	Make
Carbon County	CB05-0029	Vehicle	1983	CHEVROLET
Carbon County	CB05-0053	Vehicle	1993	CHEVROLET
Carbon County	CB05-0194	Vehicle	2007	INTERNATIONAL
Carbon County	CB05-0226	Vehicle	2003	OSHKOSH
Carbon County	CB05-0238	Vehicle	2022	CHEVROLET
Carbon County	CB05-0189	Vehicle	2018	DODGE
Carbon County	CB05-0162	Vehicle	2013	SUBARU
Carbon County	CB05-0236	Vehicle	2022	FORD
Carbon County	CB05-0201	Vehicle	2020	FORD
Carbon County	CB05-0193	Vehicle	2018	DODGE
Carbon County	CB05-0212	Trailer	2016	MIRAGE
Carbon County	CB05-0213	Trailer	2019	AERO
Carbon County	CB05-0219	Trailer	2014	BIG TEX
Carbon County	CB05-0220	ATV / UTV	2007	POLARIS
Carbon County	CB05-0221	ATV / UTV	2005	POLARIS
Carbon County	CB05-0239	Trailer	2019	SIGN MESSAGE BOARD
Carbon County	CB05-0240	Trailer	2019	SIGN MESSAGE BOARD
Carbon County	CB05-0103	ATV / UTV	2001	KAWASAKI
Carbon County	CB05-0246	Vehicle	2023	CHEVROLET
Carbon County	CB05-0200	Vehicle	2012	DODGE
Carbon County	CB05-0136	Vehicle	2008	FORD
Carbon County	CB05-0147	Vehicle	2009	CHEVROLET
Carbon County	CB05-0151	Trailer	2010	CPS
Carbon County	CB05-0144	Vehicle	2009	FREIGHTLINER
Carbon County	CB05-0145	Vehicle	2009	FREIGHTLINER
Carbon County	CB05-0156	Trailer	2011	DELTA
Carbon County	CB05-0157	Vehicle	2012	CHEVROLET
Carbon County	CB05-0107	Vehicle	2002	DODGE
Carbon County	CB05-0094	Vehicle	2000	KENWORTH
Carbon County	CB05-0095	Trailer	2000	R-WAY
Carbon County	CB05-0098	Trailer	2000	TOWMASTER
Carbon County	CB05-0099	Trailer	2001	BEALL
Carbon County	CB05-0101	Vehicle	2001	KENWORTH
Carbon County	CB05-0166	Trailer	2014	HOMEMADE
Carbon County	CB05-0176	Vehicle	1991	INTERNATIONAL
Carbon County	CB05-0177	Vehicle	1992	OSHKOSH
Carbon County	CB05-0179	Trailer	2007	LOAD TRAIL
Carbon County	CB05-0185	Vehicle	1997	CHEVROLET
Carbon County	CB05-0054	Vehicle	1993	KENWORTH
Carbon County	CB05-0056	Vehicle	1993	INTERNATIONAL
Carbon County	CB05-0064	Vehicle	1995	INTERNATIONAL
Carbon County	CB05-0065	Trailer	1996	Midland
Carbon County	CB05-0066	Vehicle	1996	OSHKOSH
Carbon County	CB05-0068	Vehicle	1996	INTERNATIONAL
Carbon County	CB05-0069	Trailer	1996	LOAD KING
Carbon County	CB05-0070	Vehicle	1996	KENWORTH
Carbon County	CB05-0042	Trailer	1990	FONTAINE

Carbon County	CB05-0043	Vehicle	1991	INTERNATIONAL
Carbon County	CB05-0045	Vehicle	1991	FORD
Carbon County	CB05-0047	Vehicle	1992	FORD
Carbon County	CB05-0048	Vehicle	1992	FORD
Carbon County	CB05-0050	Vehicle	1992	PETERBILT
Carbon County	CB05-0052	Vehicle	1993	Oshkosh
Carbon County	CB05-0019	Trailer	1976	LOAD KING
Carbon County	CB05-0022	Trailer	1977	LOAD KING
Carbon County	CB05-0024	Trailer	1990	
Carbon County	CB05-0027	Trailer	1982	WISCONSIN
Carbon County	CB05-0076	Vehicle	1997	PETERBILT
Carbon County	CB05-0081	Vehicle	1998	GMC
Carbon County	CB05-0086	Trailer	1999	RWAY
Carbon County	CB05-0087	Vehicle	1999	KENWORTH
Carbon County	CB05-0089	Vehicle	1999	FORD
Carbon County	CB05-0110	Vehicle	2003	CHEVROLET
Carbon County	CB05-0112	Vehicle	2004	CHEVROLET
Carbon County	CB05-0113	Vehicle	2004	KENWORTH
Carbon County	CB05-0115	Vehicle	2005	GMC
Carbon County	CB05-0117	Vehicle	2005	PETERBILT
Carbon County	CB05-0118	Vehicle	2005	CHEVROLET
Carbon County	CB05-0123	Vehicle	2006	CHEVROLET
Carbon County	CB05-0127	Trailer	2007	TOWMASTER
Carbon County	CB05-0128	Trailer	2006	MANAC
Carbon County	CB05-0129	Vehicle	2007	FREIGHTLINER
Carbon County	CB05-0131	Trailer	2007	Dragon
Carbon County	CB05-0244	Vehicle	2004	KENWORTH
Carbon County	CB05-0245	Vehicle	2006	KENWORTH
Carbon County	CB05-0252	Vehicle	2023	FORD
Carbon County	CB05-0253	ATV / UTV	2022	KUBOTA
Carbon County	CB05-0247	Vehicle	1989	FREIGHTLINER
Carbon County	CB05-0248	Trailer	2007	SIDU
Carbon County	CB05-0216	Vehicle	1991	OSHKOSH
Carbon County	CB05-0217	Vehicle	2020	FORD
Carbon County	CB05-0223	Vehicle	2021	DODGE
Carbon County	CB05-0224	Vehicle	1992	OSHKOSH
Carbon County	CB05-0225	Trailer	2000	R-WAY
Carbon County	CB05-0229	Vehicle	1998	FREIGHTLINER
Carbon County	CB05-0232	Vehicle	2008	KENWORTH
Carbon County	CB05-0233	Trailer	1996	CONTRAIL - TOWMASTER
Carbon County	CB05-0234	Trailer	2021	CARRY-ON
Carbon County	CB05-0235	Vehicle	2009	STERLING
Carbon County	CB05-0205	Vehicle	2009	CHEVROLET
Carbon County	CB05-0206	Vehicle	1991	OSHKOSH
Carbon County	CB05-0207	Vehicle	1988	FREIGHTLINER
Carbon County	CB05-0208	Vehicle	2009	FREIGHTLINER
Carbon County	CB05-0209	Vehicle	1992	NAVISTAR
Carbon County	CB05-0210	Trailer	1991	
Carbon County	CB05-0211	Trailer	2008	LOAD KING
Carbon County	CB05-0198	Trailer	2019	HOMEMADE
Carbon County	CB05-0199	Vehicle	2007	KENWORTH
Carbon County	CB05-0202	Trailer	2015	MIRAGE

Carbon County	CB05-0197	Sheriff	2019	DODGE
Carbon County	CB05-0214	Sheriff	2020	CHEVROLET
Carbon County	CB05-0215	Sheriff	2020	CHEVROLET
Carbon County	CB05-0227	Sheriff	2021	CHEVROLET
Carbon County	CB05-0228	Sheriff	2021	CHEVROLET
Carbon County	CB05-0218	Sheriff	2020	FORD
Carbon County	CB05-0249	Trailer	2004	CAMP MASTER
Carbon County	CB05-0250	Sheriff	2023	CHEVROLET
Carbon County	CB05-0251	Sheriff	2023	CHEVROLET
Carbon County	CB05-0241	Sheriff	2022	FORD
Carbon County	CB05-0242	Sheriff	2022	FORD
Carbon County	CB05-0243	Sheriff	2022	FORD
Carbon County	CB05-0254	Sheriff	2024	CHEVROLET
Carbon County	CB05-0186	Vehicle	2015	CHEVROLET
Carbon County	CB05-0187	Vehicle	2017	FORD
Carbon County	CB05-0188	Vehicle	2017	DODGE
Carbon County	CB05-0190	Sheriff	2018	CHEVROLET
Carbon County	CB05-0191	Sheriff	2018	CHEVROLET
Carbon County	CB05-0192	Sheriff	2007	FORD
Carbon County	CB05-0171	Sheriff	2016	FORD
Carbon County	CB05-0102	ATV / UTV	2001	KAWASAKI
Carbon County	CB05-0142	Sheriff	2008	FORD
Carbon County	CB05-0158	Sheriff	2013	FORD
Carbon County	CB05-0154	Sheriff	2011	CHEVROLET
Carbon County	CB05-0159	Vehicle	2013	FORD
Carbon County	CB05-0109	Vehicle	2003	CHEVROLET
Carbon County	CB05-0178	Trailer	2014	ITM
Carbon County	CB05-0180	Vehicle	2016	FORD
Carbon County	CB05-0183	ATV / UTV	2014	KUBOTA
Carbon County	CB05-0184	ATV / UTV	2015	KUBOTA
Carbon County	CB05-0134	Trailer	2007	
Carbon County	CB05-0091	Trailer	1999	CRYO
Carbon County	CB05-0072	Vehicle	1997	FORD
Carbon County	CB05-0222	Vehicle	2013	CHEVROLET
Carbon County	CB05-0237	Vehicle	2022	CHEVROLET
Carbon County	CB05-0195	ATV / UTV	2019	HONDA
	135			

Vehicle Export Report

Model	VIN	Active Date	Inactive Date
CK20	1GCGK24MDJ121926		
Pick Up	1GCEK14K1PZ164171		
7400SFA COMMERCIAL TRUCK	1HTWDAAN77J454428	6/10/2019	
HB-2723	10TBFWF133S077977	5/20/2021	
SILVERADO 2500HD	1GC4YME73NF281416	8/25/2022	
RAM 1500	1C6RR7FT9JS189882	4/25/2018	
OUTBACK	4F4BRCC5D3290672		
BRONCO - SPORT	3FMCR9C63NRD60809	5/31/2022	
F250	1FT7X2B64LEC73506	2/14/2020	
RAM 1500	1CRR7FT5JS185666	7/3/2018	
TRAILER	5M3BE1625G1068632	2/15/2020	
16' TRAILER	4A9BC1623KW040154	2/15/2020	
35SA	16VAX1019E4A05378	9/13/2020	
RANGER 6X6	4XARF68A774390837	9/16/2020	
RANGER 4X4	4XARD50AX5D449873	9/16/2020	
PCMS-548-S	2S9US2111KS132532	10/27/2022	
PCMS-548-S	2S9US2113KS132533	10/27/2022	
ATV	JKAVFKC181B526722		
SILVERADO 2500	1GC5YLE74PF209996	1/11/2023	
RAM 1500	1C6RD7LTXCS187709	1/22/2020	
TAURUS	1FAHP25W28G179092		
1500 EXT 4X4	1GCEK29J49Z139838		
Trailer	5MC111622AP011087		
	1FULATCG59PZ73439		
6X6 TRACTOR	1FULATCG89PZ73306		
BUMPER TRAILER	4MWBT2022BN027597		
C1500 Pickup	1GCRKSE71CZ234182		
Pickup	3B6MF36C02M293731		
T800	1NKDLB0X5YR958106		
DUMP TRAILER	1R9B54222YL168492		
F40 Trailer	4KNFT2321YU61744		
BELLY DUMP TRAILER	1BN2P402X1N009511		
T800 DUMP TRUCK	1XKDDR9X1NJ880555		
TRAILER	SNTR00138871MT		
4900	1HTSHNGR4MH311721	2/3/2018	
2518 MP3	10T3E1BXON1046133	2/3/2018	
EQUIPMENT TRAILER	4ZECF182671040302	2/3/2018	
1 TON	1GBHC34F1VF041692	2/9/2018	
Truck	1XKADR9X8PT580460		
Paystar 5070 Truck	2HTTELLRXPC075532		
DUMP TRUCK	2HSFHASR3SC033985		
Belly Dump	2M9B2S4D7TR018567		
SNOWPLOW TRUCK	10T2C0EA1T1052796		
4700 SNOWPLOW	1HTSCAAP3TH397083		
Lowboy	1TKJ05230TM114270		
T600B	1XKAD29X8T5714752		
20 TON FOUTAINE AFLT12540	13N837205M1551603		

4900	1HTSDNGNXMH339435		
F38	2FDKF38G6MCA54858		
800	1FDXK84A8NVA29570		
L-900	1FDYU90T0NVA21555		
Dump Truck	1XPCDE9X3N0311726		
HB-2518-MP2 Snowblower	10T3EIBW5P1047868		
403LF Trailer	8698NU00J4		
TRAILER	504965		
50 Ton TRANSPORT LOWBOY TRAILER	C5201		
TILT-DECK TRAILER (25 TON)	1W91SE207D1008530		
Semi truck	1XPFD8XXVN431028		
1500 SIERRA 4X4	1GTEK19R0WR506343		
Trailer	1R9B5423XXL168414		
T800	1XKDD09X5XR830750		
F800 Bucket Truck	3FEWF80C9XMA16116		
2500 SILVERADO EXT HD 4X4	1GCHK29G53E215972		
1500	1GCEK19T34E148168		
T800	1XKDD09X5XR830750		
C7CO42	1GDM7C1C95F517479	2/15/2020	
Tractor	1XP5DB9X65W851461		
1500 SILVERADO EXT 4X4	2GCEK19B151344720		
C1500 Pickup	1GCEK19Z46Z208233		
2 Axle Trailer	4KNUT20267L161832		
BELLY DUMP TRAILER	5MC1116286P006659		
	1FULATCG97PZ234026		
Belly Dump	1UNSD40217C053318		
T300 - SERVICE TRUCK	3BKMHD7XX4F067464	12/22/2022	
T800	3WKDD49XX6F145734	1/11/2023	
F250	1FT7X2BA4PED56962	9/7/2023	
	A5KC2GDBTPG082902	9/14/2023	
FLC120 - 4000 GALLON WATER TRUCK	1FUP2XYB9KP370230	12/31/2022	
SIDE DUMP TRAILER	1YPFS42377P001930	9/30/2022	
H2518 MP3 SNOW REMOVAL TRUCK	10T3E1BX5N1044992	3/9/2020	
F150	1FTEX1E58LKD80421	4/20/2020	
RAM 2500	3C6UR5HJ7MG503678	3/31/2021	
SNOWBLOWER - HB2518MP3	10T3F1BX4N1046104	4/1/2021	
SIDE DUMP TRAILER	1T9SS4021YT627032	5/20/2021	
SEMI TRUCK	1FVNCSZB4WP933420	10/13/2021	
T800	1XKDDU9X38J207201	12/14/2022	
FLATBED TRAILER	4KNFC1928TL160472	7/23/2021	
PATRIOT 7X22HDEQUILT 14	4YMBU2222MR008199	10/1/2022	
LT9500 STERLING	2FZHAWBS59AAH2820	8/1/2021	
SILVERADO 1500	1GCEK19049Z254571	2/15/2020	
HB2518MP3	10T3E1BX6N1043396	2/15/2020	
FLC120064ST	1FUJ2DYB8JP329198	2/15/2020	
M916A2	1FULATCG81PH66308	2/15/2020	
4700 4X2 FLATBED	1FTSCPLL9PH425908	2/15/2020	
23' TANDEM TILT BED	1DA12TK90MP010375	2/15/2020	
2066	5LKD4023181027521	2/15/2020	
UTILITY TRAILER	SNTR0014076MT	12/18/2019	
W900 COMMERCIAL TRUCK	1XKWD49X87R161048	1/9/2020	
TRAILER	5M3BE1018F10622452	2/15/2020	

DURANGO	1C4SDJFT0KC631921	2/15/2019	
TAHOE	1GNSKFEC0LR280647	3/25/2020	
TAHOE	1GNSKFEC4LR284880	3/25/2020	
TAHOE	1GNSKLED7MR407502	8/2/2021	
TAHOE	1GNSKLEDXMR407557	8/2/2021	
EXPLORER	1FM5K8AW7LGA19993	8/27/2020	
COMMAND TRAILER	5DT217N2441050232	3/16/2023	
TAHOE - PPV	1GNSKLED5PR337003	6/6/2023	
TAHOE - PPV	1GNSKLED8PR337030	6/6/2023	
EXPLORER - POLICE INTERCEPTOR	LFM5K8AB5NGC06889	12/5/2022	
EXPLORER - POLICE INTERCEPTOR	LFM5K8AB3NGC06924	12/5/2022	
EXPLORER - POLICE INTERCEPTOR	LFM5K8AB0NGC06993	12/5/2022	
EQUINOX	3GNAXSEG9RL197453	12/20/2023	
TAHOE	1GNSK3EC3FR557665	2/9/2018	
F-150	1FTEW1EG0HFA75628	2/9/2018	
DURANGO	1C4SDJFTXHC716693	2/9/2018	
SILVERADO 1500	3GCUKNEC8JG310440	4/25/2018	
SILVERADO 1500	3GCUKNEC8JG311750	4/25/2018	
ECONOLINE 350	1FTSS34S57DA05195	4/25/2018	
EXPLORER	1FM5K8AR9GGB65814	4/26/2016	
ATV	JKAVFKC101B526732		
Crown Victoria	2FAFP71VX8X121162		
Taurus	1FAHP2MT40G116965		
TAHOE LS	1GNSK2E00BR229047		
F-350	1FDRF3H69DEA05010		
1500 SILVERADO 4X4	1GCEK19T73E322158		
TRAILER	5PDCU2022ER012883	2/3/2018	
F-250 4X4	1FT7W2B6XGEB86542	2/3/2018	
X1100C RTV	A5KC2GDBTEF015035	2/3/2018	
X1100C RTV	A5KC2GDBEFG024445	2/3/2018	
TRAILER	4JUBF16238N030977		
TRAILER	4YMUK1212XH014708		
1 Ton	1FDKF38G4VEB11442		
SILVERADO 2500HD	1GC2KVCG0DZ104367	12/7/2020	
SILVERADO 2500HD	2GC4YME79N1228548	6/22/2022	
SXS500M ATV	1HFVE036XJ4400057	3/28/2019	

Date Totalled	Liability Only	Vehicle Dept	Ownership Type	Tag Number	Misc ID
	False	Airport	Owned		0
	True	Airport	Owned		290
	False	Airport	Owned		
	False	Airport	Owned		7977
	False	County Commissioners	Owned		115
	False	County Commissioners	Owned		113
	False	County Extension Service	Owned		0
	False	County Extension Service			0
	False	County Extension Service	Owned		454A
	False	Disaster / Emergency Services	Owned		2369
	False	Disaster / Emergency Services	Owned		2529
	False	Disaster / Emergency Services	Owned		
	True	Disaster / Emergency Services	Owned		5378
	True	Disaster / Emergency Services	Owned		
	True	Disaster / Emergency Services	Owned		
	False	Disaster / Emergency Services	Owned		
	False	Disaster / Emergency Services	Owned		
	False	Disaster / Emergency Services	Owned		362
	False	Fire Department	Owned		
	False	Health	Owned		0
	False	Health	Owned		454
	False	Health	Owned		469
	False	Road / Surveyor	Owned		524
	False	Road / Surveyor	Owned		230
	False	Road / Surveyor	Owned		231
	False	Road / Surveyor	Owned		525
8/1/2023	False	Road / Surveyor	Owned		111
	False	Road / Surveyor	Owned		104
	False	Road / Surveyor	Owned		223
	False	Road / Surveyor	Owned		515
	False	Road / Surveyor	Owned		517
	False	Road / Surveyor	Owned		518
	False	Road / Surveyor	Owned		224
	False	Road / Surveyor	Owned		505
	True	Road / Surveyor	Owned		207
	True	Road / Surveyor	Owned		211
	True	Road / Surveyor	Owned		522
	True	Road / Surveyor	Owned		102
	False	Road / Surveyor	Owned		212
	False	Road / Surveyor	Owned		214
	False	Road / Surveyor	Owned		215
	True	Road / Surveyor	Owned		511
	False	Road / Surveyor	Owned		219
	False	Road / Surveyor	Owned	10-607	216
	False	Road / Surveyor	Owned		512
	False	Road / Surveyor	Owned		218
	False	Road / Surveyor	Owned		509

	False	Road / Surveyor	Owned		206
	False	Road / Surveyor	Owned		100
	False	Road / Surveyor	Owned		210
	False	Road / Surveyor	Owned		208
	False	Road / Surveyor	Owned		209
	False	Road / Surveyor	Owned		213
	False	Road / Surveyor	Owned		503
	False	Road / Surveyor	Owned		504
	False	Road / Surveyor	Owned		506
	False	Road / Surveyor	Owned		508
	False	Road / Surveyor	Owned		220
	False	Road / Surveyor	Owned		103
	True	Road / Surveyor	Owned		513
	False	Road / Surveyor	Owned	10-644	222
	False	Road / Surveyor	Owned		221
	False	Road / Surveyor	Owned		105
	False	Road / Surveyor	Owned		106
	False	Road / Surveyor	Owned		227
	False	Road / Surveyor	Owned		233
	False	Road / Surveyor	Owned		228
	False	Road / Surveyor	Owned		107
	False	Road / Surveyor	Owned		108
	False	Road / Surveyor	Owned		521
	False	Road / Surveyor	Owned		519
	False	Road / Surveyor	Owned		229
	False	Road / Surveyor	Owned		520
	False	Road / Surveyor	Owned		239
	False	Road / Surveyor	Owned		240
	False	Road / Surveyor	Owned		111
	False	Road / Surveyor	Owned		
	False	Road / Surveyor	Owned		241
	False	Road / Surveyor	Owned		528
	False	Road / Surveyor	DNRC		235
	False	Road / Surveyor	Owned		109A
	False	Road / Surveyor	Owned		3678
	False	Road / Surveyor	Owned		6104
	False	Road / Surveyor	Owned		7032
	False	Road / Surveyor	Owned		236
	False	Road / Surveyor	Owned		238
	False	Road / Surveyor	Owned		472
	False	Road / Surveyor	Owned		527
	False	Road / Surveyor	Owned		237
	False	Road / Surveyor	Owned		110
	False	Road / Surveyor	Owned		204
	False	Road / Surveyor	Owned		205
	False	Road / Surveyor	Owned		232
	False	Road / Surveyor	Owned		234
	False	Road / Surveyor	Owned		510
	False	Road / Surveyor	Owned		523
	False	Road / Surveyor	Owned		529
	False	Road / Surveyor	Owned		226A
	False	Sheriff	Owned		

	False	Sheriff	Owned		
	False	Sheriff	Owned		10-1
	False	Sheriff	Owned		10-7
	False	Sheriff	Owned		
	False	Sheriff	Owned		
	False	Sheriff	Owned		
	False	Sheriff	Owned	10-5610E	0232
	False	Sheriff	Owned		7003
	False	Sheriff	Owned		7030
	False	Sheriff	Owned		10-13
	False	Sheriff	Owned		10-4
	False	Sheriff	Owned		10-10
	False	Sheriff	Owned		7453
	False	Sheriff	Owned		0
	False	Sheriff	Owned		0
	False	Sheriff	Owned		0
	False	Sheriff	Owned		
	False	Sheriff	Owned		
	False	Sheriff	Owned		0
	False	Sheriff	Owned		0
	False	Sheriff	Owned		0
	False	Sheriff	Owned		0
	False	Sheriff	Owned		2354
	False	Weed Control	Owned		2346
	False	Weed Control	Owned		382
	True	Weed Control	Owned		0
	False	Weed Control	Owned		0
	False	Weed Control	Owned		0
	False	Weed Control	Owned		0
	False	Weed Control	Owned		0
	False	Weed Control	Owned		0
	True	Weed Control	Owned		0
	False	Weed Control	Owned		321
	False	Weed Control	Owned		405
	False	Weed Control	Owned		
	False	Weed Control	Owned		

Misc Dept	Misc Info	Actual Cash Value
220		12,000.00
220		0.00
220	INCLUDES SANDER & SNOWPLOW WING	31,500.00
220		350,000.00
201		44,120.00
201		25,300.00
215	SANITARIAN	25,000.00
215	Sanitarium/Environmental Health	33,418.40
249		29,908.00
252		42,770.00
252		5,000.00
252		7,763.00
252	Single Axle Utility Trlr	0.00
252		0.00
252		0.00
252	Sign/Message Board (on Trailer) #1	12,540.00
252	Sign/Message Board (on Trailer) #2	12,540.00
252		4,000.00
GIS/Fire		46,255.00
214	PUBLIC HEALTH	27,500.00
249	PUBLIC HEALTH	22,000.00
201	PUBLIC HEALTH	23,000.00
218-2		10,000.00
218-3		75,000.00
218-1		75,000.00
218-3		10,000.00
218-3	Salvage Sold to Hanser's	28,000.00
218-2		20,000.00
218-1		75,000.00
218-3		20,000.00
218-2		13,370.00
218-1		24,000.00
218-2		40,000.00
218-3		5,000.00
218-1		0.00
218-1		0.00
218-1		0.00
218-3		0.00
218-2		16,000.00
218-3		30,000.00
218-3		30,000.00
218-3		0.00
218-2		20,000.00
218-1	HENDERSON 10X24XUB BOX & HOIST, 4 YD3 CAPACITY - HDSA-14748	10,000.00
218-1		24,500.00
218-2		25,000.00
218-3		21,003.00

218-1		20,000.00
218-2		18,000.00
218-3		25,000.00
218-1		25,000.00
218-3		30,000.00
218-3		190,000.00
218-2		10,000.00
218-1		10,000.00
218-3		22,057.00
218-2		10,000.00
218-3		25,000.00
218-2		5,000.00
218-3		0.00
218-1	BIMBEAU MODEL BFL-5 12 YD3 DUMP BOX & HOIST - B14870-1	25,000.00
218-1		16,000.00
218-1		26,000.00
218-2		15,000.00
218-2	BLUE	25,000.00
218-3	Topkick White Service Truck	32,000.00
218-3		38,000.00
218-3		20,000.00
218-3		24,400.00
218-2		7,500.00
218-2		25,000.00
218-2		70,000.00
218-1		29,500.00
218-1		65,000.00
218-1		51,492.00
218		52,420.00
Road 218	INCLUDES - V SNOW PLOW	22,132.00
218-2		40,000.00
218-1		35,000.00
218-3	MT DNRC Via COLORADO SPRINGS	583,760.00
218-1		28,942.76
218-3		30,000.00
218-3		500,000.00
218-3		35,000.00
218-1		32,500.00
218-1		50,000.00
218-1	BLACK	5,500.00
218-1	Tandem Axle 22'	9,458.00
218-2		40,000.00
218-1	1/2 ton pickup, black, 4x4	10,000.00
218-2		98,000.00
218-3		40,000.00
218-2	INVALID VIN#	120,000.00
218-2		19,000.00
218-3	EQUIPMENT TRAILER	13,800.00
218-1		19,500.00
218-3	INCLUDES HOTSY ATTACHMENT	11,500.00
218-3		49,000.00
209		2,640.00

209		32,979.00
209		39,000.00
209		38,450.00
209		38,879.00
209		38,879.00
209		38,114.00
209 Sheriff	COMMAND TRAILER	5,000.00
209 Sheriff		61,287.00
209 Sheriff		61,287.00
2096		37,000.00
209		37,000.00
209		37,000.00
209 Sheriff	Mahoney	30,000.00
209		33,155.00
209		29,698.00
209		31,629.00
209		31,046.00
209		31,046.00
209		6,000.00
209		35,000.00
209		4,000.00
209		18,000.00
209		26,000.00
215	Sanitarian	32,000.00
246		30,000.00
246		15,000.00
246		0.00
246		32,372.00
246		20,330.00
246		23,113.00
246		6,000.00
246		0.00
246		26,000.00
246		24,900.00
246		43,920.00
246	GREEN	9,248.00
		5,037,921.16

Additional Equipment Value	Total Value	Member	Vehicle Dept
0.00	12,000.00	Carbon County	Airport
0.00	0.00	Carbon County	Airport
0.00	31,500.00	Carbon County	Airport
0.00	350,000.00	Carbon County	Airport
0.00	44,120.00	Carbon County	County Commissioners
0.00	25,300.00	Carbon County	County Commissioners
0.00	25,000.00	Carbon County	County Extension Service
0.00	33,418.40	Carbon County	County Extension Service
0.00	29,908.00	Carbon County	County Extension Service
0.00	42,770.00	Carbon County	Disaster / Emergency Services
0.00	5,000.00	Carbon County	Disaster / Emergency Services
0.00	7,763.00	Carbon County	Disaster / Emergency Services
0.00	0.00	Carbon County	Disaster / Emergency Services
0.00	0.00	Carbon County	Disaster / Emergency Services
0.00	0.00	Carbon County	Disaster / Emergency Services
0.00	12,540.00	Carbon County	Disaster / Emergency Services
0.00	12,540.00	Carbon County	Disaster / Emergency Services
0.00	4,000.00	Carbon County	Disaster / Emergency Services
0.00	46,255.00	Carbon County	Fire Department
0.00	27,500.00	Carbon County	Health
0.00	22,000.00	Carbon County	Health
0.00	23,000.00	Carbon County	Health
0.00	10,000.00	Carbon County	Road / Surveyor
0.00	75,000.00	Carbon County	Road / Surveyor
0.00	75,000.00	Carbon County	Road / Surveyor
0.00	10,000.00	Carbon County	Road / Surveyor
2,500.00	30,500.00	Carbon County	Road / Surveyor
0.00	20,000.00	Carbon County	Road / Surveyor
0.00	75,000.00	Carbon County	Road / Surveyor
0.00	20,000.00	Carbon County	Road / Surveyor
0.00	13,370.00	Carbon County	Road / Surveyor
0.00	24,000.00	Carbon County	Road / Surveyor
0.00	40,000.00	Carbon County	Road / Surveyor
0.00	5,000.00	Carbon County	Road / Surveyor
0.00	0.00	Carbon County	Road / Surveyor
0.00	0.00	Carbon County	Road / Surveyor
0.00	0.00	Carbon County	Road / Surveyor
0.00	0.00	Carbon County	Road / Surveyor
0.00	0.00	Carbon County	Road / Surveyor
0.00	16,000.00	Carbon County	Road / Surveyor
0.00	30,000.00	Carbon County	Road / Surveyor
0.00	30,000.00	Carbon County	Road / Surveyor
0.00	0.00	Carbon County	Road / Surveyor
0.00	20,000.00	Carbon County	Road / Surveyor
0.00	10,000.00	Carbon County	Road / Surveyor
0.00	24,500.00	Carbon County	Road / Surveyor
0.00	25,000.00	Carbon County	Road / Surveyor
0.00	21,003.00	Carbon County	Road / Surveyor

0.00	20,000.00	Carbon County	Road / Surveyor
0.00	18,000.00	Carbon County	Road / Surveyor
0.00	25,000.00	Carbon County	Road / Surveyor
0.00	25,000.00	Carbon County	Road / Surveyor
0.00	30,000.00	Carbon County	Road / Surveyor
0.00	190,000.00	Carbon County	Road / Surveyor
0.00	10,000.00	Carbon County	Road / Surveyor
0.00	10,000.00	Carbon County	Road / Surveyor
0.00	22,057.00	Carbon County	Road / Surveyor
0.00	10,000.00	Carbon County	Road / Surveyor
0.00	25,000.00	Carbon County	Road / Surveyor
0.00	5,000.00	Carbon County	Road / Surveyor
0.00	0.00	Carbon County	Road / Surveyor
0.00	25,000.00	Carbon County	Road / Surveyor
0.00	16,000.00	Carbon County	Road / Surveyor
0.00	26,000.00	Carbon County	Road / Surveyor
0.00	15,000.00	Carbon County	Road / Surveyor
0.00	25,000.00	Carbon County	Road / Surveyor
0.00	32,000.00	Carbon County	Road / Surveyor
0.00	38,000.00	Carbon County	Road / Surveyor
0.00	20,000.00	Carbon County	Road / Surveyor
0.00	24,400.00	Carbon County	Road / Surveyor
0.00	7,500.00	Carbon County	Road / Surveyor
0.00	25,000.00	Carbon County	Road / Surveyor
0.00	70,000.00	Carbon County	Road / Surveyor
0.00	29,500.00	Carbon County	Road / Surveyor
0.00	65,000.00	Carbon County	Road / Surveyor
0.00	51,492.00	Carbon County	Road / Surveyor
0.00	52,420.00	Carbon County	Road / Surveyor
7,821.00	29,953.00	Carbon County	Road / Surveyor
0.00	40,000.00	Carbon County	Road / Surveyor
0.00	35,000.00	Carbon County	Road / Surveyor
0.00	583,760.00	Carbon County	Road / Surveyor
3,000.00	31,942.76	Carbon County	Road / Surveyor
0.00	30,000.00	Carbon County	Road / Surveyor
0.00	500,000.00	Carbon County	Road / Surveyor
0.00	35,000.00	Carbon County	Road / Surveyor
0.00	32,500.00	Carbon County	Road / Surveyor
0.00	50,000.00	Carbon County	Road / Surveyor
0.00	5,500.00	Carbon County	Road / Surveyor
0.00	9,458.00	Carbon County	Road / Surveyor
0.00	40,000.00	Carbon County	Road / Surveyor
0.00	10,000.00	Carbon County	Road / Surveyor
0.00	98,000.00	Carbon County	Road / Surveyor
0.00	40,000.00	Carbon County	Road / Surveyor
0.00	120,000.00	Carbon County	Road / Surveyor
0.00	19,000.00	Carbon County	Road / Surveyor
0.00	13,800.00	Carbon County	Road / Surveyor
0.00	19,500.00	Carbon County	Road / Surveyor
0.00	11,500.00	Carbon County	Road / Surveyor
2,500.00	51,500.00	Carbon County	Road / Surveyor
0.00	2,640.00	Carbon County	Sheriff

12,000.00	44,979.00	Carbon County	Sheriff
12,000.00	51,000.00	Carbon County	Sheriff
12,000.00	50,450.00	Carbon County	Sheriff
20,500.00	59,379.00	Carbon County	Sheriff
20,500.00	59,379.00	Carbon County	Sheriff
12,500.00	50,614.00	Carbon County	Sheriff
0.00	5,000.00	Carbon County	Sheriff
20,000.00	81,287.00	Carbon County	Sheriff
20,000.00	81,287.00	Carbon County	Sheriff
15,000.00	52,000.00	Carbon County	Sheriff
15,000.00	52,000.00	Carbon County	Sheriff
15,000.00	52,000.00	Carbon County	Sheriff
15,000.00	45,000.00	Carbon County	Sheriff
12,000.00	45,155.00	Carbon County	Sheriff
11,878.00	41,576.00	Carbon County	Sheriff
12,128.00	43,757.00	Carbon County	Sheriff
12,000.00	43,046.00	Carbon County	Sheriff
12,000.00	43,046.00	Carbon County	Sheriff
0.00	6,000.00	Carbon County	Sheriff
12,000.00	47,000.00	Carbon County	Sheriff
0.00	4,000.00	Carbon County	Sheriff
0.00	18,000.00	Carbon County	Sheriff
12,000.00	38,000.00	Carbon County	Sheriff
12,000.00	44,000.00	Carbon County	Sheriff
0.00	30,000.00	Carbon County	Weed Control
0.00	15,000.00	Carbon County	Weed Control
0.00	0.00	Carbon County	Weed Control
0.00	32,372.00	Carbon County	Weed Control
0.00	20,330.00	Carbon County	Weed Control
0.00	23,113.00	Carbon County	Weed Control
0.00	6,000.00	Carbon County	Weed Control
0.00	0.00	Carbon County	Weed Control
0.00	26,000.00	Carbon County	Weed Control
0.00	24,900.00	Carbon County	Weed Control
0.00	43,920.00	Carbon County	Weed Control
0.00	9,248.00	Carbon County	Weed Control
301,327.00	5,339,248.16		

Client Name:	<i>MACo</i>
Report Name:	<i>^Active Vehicle Report- All Fields</i>
Description:	<i>Active Vehicle Report</i>
Filter:	<i>Inactive Date is empty</i>
Group By:	<i>Member then Vehicle Dept</i>
Sort By:	<i>No Sorts</i>
Options:	<i>None</i>
Run Date:	<i>01/03/2024</i>

Carbon County

Renewal Application for Policy Starting: 7/1/2024

GENERAL INFORMATION

Member Carbon County
Address PO Box 887
Red Lodge, MT 59068-0887
FYE Date 6/30/2025
FYE Budget
Transit Miles
Designated Safety Coordinator Pam Schwend

PROPERTY COVERAGES

Property Deductible 500.00
Auto Physical Damage Deductible 2,500.00

FIDELITY & CRIME COVERAGES

Crime Deductible 2,000.00

LIABILITY COVERAGES

General Liability Deductible 2,000.00
E & O Deductible 5,000.00
Employee Benefits 5,000.00
Sexual Assault 5,000.00
Auto Liability Deductible 1,000.00

PROFESSIONAL SERVICES INDEMNITY

Total Number of Nurses
Total Number of Other Emergency Professionals
Total Number of Public Health Officer
Total Number of Social Workers/Nutritionists

OTHER VOLUNTEERS

County Appointed Board Checklist Fair, Airport, Planning, Weed
Other Boards
Total Number of Appointed Board Members
Total Number of Other Volunteers
Sponsored Events 4H Fair at Fairgrounds

LAW ENFORCEMENT INDEMNITY

Total Number of Officers
Do you have a jail/detention center?
If yes, how many beds?
Law Enforcement Deductible 5,000.00

Carbon County

Renewal Application for Policy Starting: 7/1/2024

PUBLIC OFFICIALS ERRORS & OMISSIONS

In the past year, has any person, former employee or job applicant made any claim alleging unfair or improper treatment regarding hiring, renumeration, advancement or termination?

Answer No

If yes, provide description

Has MACo PCT been notified of the claim(s)?

In the past year, have any disputes involving integration, segregation, discrimination or violations of Civil Rights arisen?

Answer No

If yes, provide description

Has MACo PCT been notified of the claim(s)?

Do you currently follow a formal written grievance procedure for employee disputes/complaints?

Answer Yes

Do you have knowledge or information of any incident or occurrence which might give rise to a claim being made?

Answer No

If yes, provide description

Has MACo PCT been notified of the claim(s)?

OPTIONAL COUNTY ENDORSEMENTS

	Deductible*
Zoning Commission Liability	<u>10,000.00</u>
Ethical Violation Liability	<u>10,000.00</u>
Flood Plain Regulation Enforcement Liability	

*Only appears if coverage has been chosen.

AGENCY INFORMATION

Agency HUB International Mountain States Limited (Red Lodge)
Address PO Box 710
Red Lodge, MT 59068
Phone Number (406) 200-6962
Agent of Record Cope, Heather (41)
Agent Email heather.cope@hubinternational.com

FINALIZING YOUR APPLICATION

If you have any questions regarding coverages or their limits, please contact Shannon Chamberlain.

Name of person responsible for completion and accuracy of this questionnaire:

Cope, Heather (41)

Montana Association of Counties
Property & Casualty Trust
2717 Skyway Dr, Ste C
Helena, MT 59602

Phone: 406-449-4370
Fax: 406-443-4161
Email: smsr@mtcounties.org



Montana Association of Counties

Property & Casualty Trust

ACKNOWLEDGEMENT FORM

**2024-2025 PCT RENEWAL
SCHEDULED PROPERTY**

_____ County, in conjunction with their agent, has reviewed the three schedules (Buildings, Vehicles, and Equipment) and have made the necessary updates, deletions and additions.

Furthermore, we understand that:

- (1) Coverage may be denied if the property in question is not properly scheduled or on file with MACo PCT.
- (2) The renewal premium is calculated off the scheduled values, so it's important to thoroughly review the items and values.
- (3) If a scheduled item lacks a value, the County has not paid premium for that property; thus, the item is insured for liability only even if the Liability Only option states "No".
- (4) Changes to any of the three schedules should be done through the online Portal in a timely fashion.

I hereby certify that I am an authorized agent to sign on behalf of this County.

Authorized Name (Printed)

Title

Authorized Signature

Date

Agent Signature

Date

PLEASE FILL OUT THIS FORM IN ITS ENTIRETY AND THEN SUBMIT BACK TO MACo. YOU MAY SUBMIT THE FORM VIA MAIL, EMAIL at bknopf@mtcounties.org OR FAX 406-443-4161.



MONTANA
HISTORICAL SOCIETY

State Historic
Preservation Office

Memorandum

To: Historic Preservation Officers
From: Kate Hampton, CLG Coordinator
Date: January 2, 2024
Re: CLG Grant Application for 2024-2025

For this grant cycle, we will continue the semi-annual and final reporting/reimbursement cycle. Quarterly requests for reimbursement, not to exceed half of the total grant, can continue to be submitted, as long there is sufficient cash and in-kind match for the amount requested (\$40 of matching funds for every \$60 of grant funds). **Please remember to provide sufficient documentation to determine the allowability of the charges reimbursed, including pay stubs, invoices, donated services forms with original signatures, and other supporting documents.**

Requests to reimburse the full amount of funding can be submitted with the six-month progress report, as long as sufficient activity and match has been documented.

2024-2024 Schedule – Dates to Remember

January 5, 2024	Announcement of Funds
February 15, 2024	CLG Grant Applications Due to SHPO
Upon Receipt and Approval	SHPO Mails CLG Agreements for Signatures
March 22, 2024	Both Signed Agreements to SHPO
April 1, 2024	12-Month Funding Cycle Begins
September 30, 2024	Mid-Point of Funding Cycle
October 31, 2024	Six-Month Progress Report & Request for Reimbursement due
March 31, 2025	Funding Cycle Ends
April 30, 2025	Final Progress Report and Request for Reimbursement due

Grant for 2022-2023:

As of this writing, the US Congress has not appropriated this federal fiscal year's budget. However, we anticipate offering annual grants for up to \$6000. Those who received \$2000 -\$4000 last year may apply for \$2000 or up to \$6000 - please consult with MT SHPO. However, until the US Congress has finalized the appropriation, the CLG grants are subject to increase or decrease. Enclosed you will find the annual grant application that MT SHPO offers for certified CLGs.

CLG Program Grant Application Due: Wednesday, February 15, 2024
Digital submissions preferred. Email to: khampton@mt.gov

CLG Application Notes and CLG Reminders:

1. Remember annual CLG training is required. At least one person from each CLG's preservation program must attend a SHPO-approved training between April 1, 2023 and March 31, 2024.
2. The state mileage rate is **\$0.670** per mile. The lodging reimbursement rate is **\$107.00** per night plus taxes (may vary by location, check with SHPO for rates).
3. Volunteer time reimbursement rate is **\$27.87** (unless a person is volunteering their time in an official professional capacity; then they can record their regular professional services pay rate. This rate shall not exceed the maximum daily rate of compensation in the Federal Civil Service equal to 120 percent of a GS-15, step 10 salary (According to [FederalPay.org](https://www.federalpay.org) as of January 2023, up to a **maximum \$102.23/hr.**, in place of the volunteer rate).
4. Please attach a list of the historic preservation board members, their professional discipline or citizen membership, term (year ending) and contact information (include email addresses if available). Please notify us of any changes that have occurred. If you have new board members, please send us their current resume for our record.
5. Please continue submitting your meeting minutes with your progress reports. They have been very helpful with our reporting requirements. Agendas are helpful but not necessary.
6. For CLGs that have design review responsibilities, please track the number of reviews you complete over the course of the grant period.
7. In the Scope of Work, please tie your tasks to your local government's and/or historic preservation commission's Preservation Plan. If not, please explain why.
8. Consider looking to other state and federal grants to supplement your program. Remember, the SHPO CLG grant cannot be used as federal match, or vice versa.

Annual CLG Program Funding

We anticipate 15 Montana communities enrolling in the CLG program this grant cycle. Each year, we are required by the National Park Service to pass-through at least 10% of our annual funding to CLGs. This coming year, we anticipate allocating \$90,000.00 to the CLGs via annual grants. Investment in the CLG program is not only a wise use of our funds but crucial to preservation efforts in our state, and we will continue to look for opportunities to increase CLG funding.

We stress public outreach in the CLG program. Please continue your outreach programs and develop new ones to involve all ages in your community. Please also consider programs and projects that have tangible/measurable outcomes.

Please provide a copy of this correspondence to your CLG Board or Commission for their review and assistance. The application form requires a copy of your meeting minutes that confirm your application was discussed and approved by the Board/Commission.

Please verify the current Tax-ID for your organization, or the organization through which you receive your payments. (your CLG local government)

Guidelines for 2022-2023 CLG Grant Eligibility

CLG guidelines include the following:

1. CLG program grants must be matched on at least a 60/40 basis, cash and/or in-kind.
2. To qualify for the maximum 12-month funding level – \$6,000.00 – CLGs must have a Historic Preservation Officer working at least 80 hours per month. The local historic preservation program must have an established address, telephone number, and message retrieval system. (Hours may not be carried forward or back into another month.)
3. All CLGs must maintain a historic preservation commission that meets at least quarterly.
4. Maximum grant amount of \$6,000.00 can be used towards projects directly associated with the local historic preservation program. Grant expenditures on SHPO-approved, tangible/measurable projects strongly preferred. Matching funds and grant fund expenditures may also include HPO salaries. Overhead/administrative costs should not exceed 25% of the grant or matching funds. **Check with SHPO to ensure your proposed project qualifies for funding under the grant. Bricks and mortar projects must meet SOI standards, benefit a NR-listed property, and complete Section 106 and NEPA review prior to the beginning of the project.** Minimum match is \$4,000.00, and match above minimum is always greatly appreciated.
5. CLGs must submit a Six-Month Progress Report and a Final Report, including meeting minutes, and Requests for Reimbursement that meet documentation and reporting requirements and are delivered on-time.
6. Unspent CLG funds revert to SHPO. Reverting funds may jeopardize the CLG's future funding.

For more guidance on administering CLG funds in Montana, please refer to the *Montana Certified Local Government Manual*, https://mhs.mt.gov/Shpo/docs/CLG_Manual.pdf, as well as the NPS Historic Preservation Fund Grants Manual, https://dpr.vi.gov/wp-content/uploads/2021/02/HPF_-Grants-Manual-419-Pages.pdf

Components of 2024-2025 Complete Grant Application

1. Completed CLG Application form, including:
 - a. Contact information
 - b. Scope of work
 - c. Detailed budget table
 - d. Sources of revenue/funding
 - e. Signed CLG and Commission form
2. List of current CLG Commission members (including contact information, i.e. email)
3. An electronic version of the Preservation Plan. Either a link to where the plan is available on the web or via email to Kate.
4. Copy of Tax ID/Employer Identification Number, if new.

If you have any questions regarding this application, please contact us:

CLG Program and financial Inquiries:

Kate Hampton
406-444-7742
khampton@mt.gov

Certified Local Government Grant Application

**For the grant period
April 1, 2024 to March 31, 2025**

Application Deadline

February 15, 2024

**Montana State Historic Preservation Office
PO Box 201202
Helena, MT 59620-1202
(406) 444-7715**

**2024-2025 GRANT APPLICATION
CERTIFIED LOCAL GOVERNMENT PROGRAM**

Certified Local Government: Carbon County

Address: PO Box 881, 224 Broadway Ave. North, Red Lodge, MT 59068

Contact Person: Rebecca Van Horn

Tax ID: 81:600139

Unique Entity Identifier (UEI): _____

Period of Grant Request: April 1, 2024 to March 31, 2025

Scope of Work: The National Park Service asks we grant funds to CLGs for kinds and levels of work that reflect increasing sophistication, skills, and roles by the Preservation Officers, in other words, tasks that reflect improvement in community thinking. For this section, please itemize special projects, products or projects starting or completing, meetings to be attended, regular work duties, etc., and specifically, ways in which the federal grant funds will help a project or program beneficial to the growth and development of the local program. Please tie your tasks to your community's Preservation Plan. If not, please explain.

Check if Scope of Work is continued on additional pages.)

Organization: Organize and attend Carbon County Historic Preservation Commission meetings to ensure implementation of County-wide preservation activities. Attend workshops and other training, offered online, as provided, to stay current with current Federal and state initiatives. *Part 1 CCPP (Carbon County Preservation Plan)*

Identification: Maintain appropriate records of historic properties in Carbon County. Identify properties that may be eligible for listing in the National Register of Historic Places, and as necessary seek funds to complete nominations. *(Part 3 CCPP)*

Review and Compliance: Assist local governments and Federal agencies with review of actions that may affect historic properties. This may be through formal reviews required by Section 106 or by local ordinances. *(Part 5 CCPP)*

Preservation Planning: Ensure preservation planning is integrated in Carbon County and its communities by attending appropriate meetings, city & town council meetings, local board meetings, and any other public meetings to ensure historic preservation is considered in proposed actions. As appropriate, review and update the Carbon County Historic Preservation Plan and make the plan available to local governments, private and public organizations and the general public. *(Part 5 CCPP)*

Public Education: Participate in public education and outreach by assisting community members and professionals researching historic properties, conducting tours; making public presentations; and assisting the Carbon County Museum in its public outreach activities. *(Part 6 CCPP)*

BUDGET

4-1-2024 to 3-31-2025 Budget	Cash Amount	Cash Source	In-kind Amount	In-kind Source	Total
A. Salaries, Wages, Benefits					
B. Office Rental					
C. Equipment					
D. Supplies & Materials Itemize major categories					
E. Postage					
F. Telephone & Internet					
G. Photocopies					
H. Preservation Commission Number of hours X * rate X number of members X number of meetings					
I. Volunteers Hours X * rate X number of volunteers.					

J. Travel Mileage Number of miles X \$0.67. Include funds for HPO and/or Commissioners to attend CLG annual training					
K. Travel Meals # of Meals X rate: Breakfast - \$8.25 Lunch - \$9.25 Dinner - \$16.00					
L. Lodging \$107.00 plus tax X number of nights					
M. Project (s) Expenses – fully itemized					
N. Other Expenses – fully itemized.					
M. Total Expenses					

SOURCE KEY:

- F-Federal**
- CI-City**
- CO-County**
- NP- Private/Non-Profit**

* Federally approved minimum rate for volunteers is \$27.87 per hour.

SOURCES OF REVENUE/FUNDING

AMOUNT

Itemized Cash Match Source

Salaries/Wages, Benefits (CCHS)

Supplies & Materials (CCHS)

Postage (CCHS)

Telephone & Internet (CCHS)

Mileage (CCHS)

Lodging (CCHS)

Travel Meals (CCHS)

Itemized In-Kind Match Source

Office Rental (CCHS)

Photocopies (CCHS)

Preservation Commission Time

Federal HPF Grant Request from SHPO

Salaries/Wages & Benefits

TOTAL REVENUE

Certified Local Government
Historic Preservation Commission Chairperson or President

Signature _____ Date _____

Name (typed) Matt Stump

Address _____

Telephone 4069629838

Certified Local Government
Chief Elected Official

Signature _____ Date _____

Name (typed) _____

Title _____

Address _____

Telephone _____

(The local government administrator may sign **in addition** to the Chief Elected Official.)

Certified Local Government
Historic Preservation Officer

Signature _____ Date _____

Name (typed) Rebecca Van Horn

Address PO Box 2368 Red Lodge, MT 59068

Telephone (406) 446-3667

Please attach the meeting minutes (or an alternate way in writing) at which your application was discussed and approved by the Preservation Board/Commission.

Please attach a list of the historic preservation board members' names citizen membership, terms (year ending), their professional discipline or status as a citizen member on the board, and contact information.

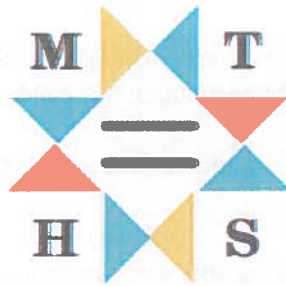

MONTANA
HISTORICAL SOCIETY

State Historic
Preservation Office

Memorandum

To: Historic Preservation Officers
From: Kate Hampton, CLG Coordinator
Date: January 2, 2024
Re: CLG Grant Application for 2024-2025

For this grant cycle, we will continue the semi-annual and final reporting/reimbursement cycle. Quarterly requests for reimbursement, not to exceed half of the total grant, can continue to be submitted, as long there is sufficient cash and in-kind match for the amount requested (\$40 of matching funds for every \$60 of grant funds). **Please remember to provide sufficient documentation to determine the allowability of the charges reimbursed, including pay stubs, invoices, donated services forms with original signatures, and other supporting documents.**

Requests to reimburse the full amount of funding can be submitted with the six-month progress report, as long as sufficient activity and match has been documented.

2024-2024 Schedule – Dates to Remember

January 5, 2024	Announcement of Funds
February 15, 2024	CLG Grant Applications Due to SHPO
Upon Receipt and Approval	SHPO Mails CLG Agreements for Signatures
March 22, 2024	Both Signed Agreements to SHPO
April 1, 2024	12-Month Funding Cycle Begins
September 30, 2024	Mid-Point of Funding Cycle
October 31, 2024	Six-Month Progress Report & Request for Reimbursement due
March 31, 2025	Funding Cycle Ends
April 30, 2025	Final Progress Report and Request for Reimbursement due

Grant for 2022-2023:

As of this writing, the US Congress has not appropriated this federal fiscal year's budget. However, we anticipate offering annual grants for up to \$6000. Those who received \$2000 - \$4000 last year may apply for \$2000 or up to \$6000 - please consult with MT SHPO. However, until the US Congress has finalized the appropriation, the CLG grants are subject to increase or decrease. Enclosed you will find the annual grant application that MT SHPO offers for certified CLGs.

CLG Program Grant Application Due: Wednesday, February 15, 2024
Digital submissions preferred. Email to: khampton@mt.gov

CLG Application Notes and CLG Reminders:

1. Remember annual CLG training is required. At least one person from each CLG's preservation program must attend a SHPO-approved training between April 1, 2023 and March 31, 2024.
2. The state mileage rate is **\$0.670** per mile. The lodging reimbursement rate is **\$107.00** per night plus taxes (may vary by location, check with SHPO for rates).
3. Volunteer time reimbursement rate is **\$27.87** (unless a person is volunteering their time in an official professional capacity; then they can record their regular professional services pay rate. This rate shall not exceed the maximum daily rate of compensation in the Federal Civil Service equal to 120 percent of a GS-15, step 10 salary (According to [FederalPay.org](https://www.federalpay.org) as of January 2023, up to a **maximum \$102.23/hr.**, in place of the volunteer rate).
4. Please attach a list of the historic preservation board members, their professional discipline or citizen membership, term (year ending) and contact information (include email addresses if available). Please notify us of any changes that have occurred. If you have new board members, please send us their current resume for our record.
5. Please continue submitting your meeting minutes with your progress reports. They have been very helpful with our reporting requirements. Agendas are helpful but not necessary.
6. For CLGs that have design review responsibilities, please track the number of reviews you complete over the course of the grant period.
7. In the Scope of Work, please tie your tasks to your local government's and/or historic preservation commission's Preservation Plan. If not, please explain why.
8. Consider looking to other state and federal grants to supplement your program. Remember, the SHPO CLG grant cannot be used as federal match, or vice versa.

Annual CLG Program Funding

We anticipate 15 Montana communities enrolling in the CLG program this grant cycle. Each year, we are required by the National Park Service to pass-through at least 10% of our annual funding to CLGs. This coming year, we anticipate allocating \$90,000.00 to the CLGs via annual grants. Investment in the CLG program is not only a wise use of our funds but crucial to preservation efforts in our state, and we will continue to look for opportunities to increase CLG funding.

We stress public outreach in the CLG program. Please continue your outreach programs and develop new ones to involve all ages in your community. Please also consider programs and projects that have tangible/measurable outcomes.

Please provide a copy of this correspondence to your CLG Board or Commission for their review and assistance. The application form requires a copy of your meeting minutes that confirm your application was discussed and approved by the Board/Commission.

Please verify the current Tax-ID for your organization, or the organization through which you receive your payments. (your CLG local government)

Guidelines for 2022-2023 CLG Grant Eligibility

CLG guidelines include the following:

1. CLG program grants must be matched on at least a 60/40 basis, cash and/or in-kind.
2. To qualify for the maximum 12-month funding level – \$6,000.00 – CLGs must have a Historic Preservation Officer working at least 80 hours per month. The local historic preservation program must have an established address, telephone number, and message retrieval system. (Hours may not be carried forward or back into another month.)
3. All CLGs must maintain a historic preservation commission that meets at least quarterly.
4. Maximum grant amount of \$6,000.00 can be used towards projects directly associated with the local historic preservation program. Grant expenditures on SHPO-approved, tangible/measurable projects strongly preferred. Matching funds and grant fund expenditures may also include HPO salaries. Overhead/administrative costs should not exceed 25% of the grant or matching funds. **Check with SHPO to ensure your proposed project qualifies for funding under the grant. Bricks and mortar projects must meet SOI standards, benefit a NR-listed property, and complete Section 106 and NEPA review prior to the beginning of the project.** Minimum match is \$4,000.00, and match above minimum is always greatly appreciated.
5. CLGs must submit a Six-Month Progress Report and a Final Report, including meeting minutes, and Requests for Reimbursement that meet documentation and reporting requirements and are delivered on-time.
6. Unspent CLG funds revert to SHPO. Reverting funds may jeopardize the CLG's future funding.

For more guidance on administering CLG funds in Montana, please refer to the *Montana Certified Local Government Manual*, https://mhs.mt.gov/Shpo/docs/CLG_Manual.pdf, as well as the NPS Historic Preservation Fund Grants Manual, https://dpr.vi.gov/wp-content/uploads/2021/02/HPF_Grants-Manual-419-Pages.pdf

Components of 2024-2025 Complete Grant Application

1. Completed CLG Application form, including:
 - a. Contact information
 - b. Scope of work
 - c. Detailed budget table
 - d. Sources of revenue/funding
 - e. Signed CLG and Commission form
2. List of current CLG Commission members (including contact information, i.e. email)
3. An electronic version of the Preservation Plan. Either a link to where the plan is available on the web or via email to Kate.
4. Copy of Tax ID/Employer Identification Number, if new.

If you have any questions regarding this application, please contact us:

CLG Program and financial Inquiries:

Kate Hampton
406-444-7742
khampton@mt.gov

Certified Local Government Grant Application

**For the grant period
April 1, 2024 to March 31, 2025**

Application Deadline

February 15, 2024

**Montana State Historic Preservation Office
PO Box 201202
Helena, MT 59620-1202
(406) 444-7715**

**2024-2025 GRANT APPLICATION
CERTIFIED LOCAL GOVERNMENT PROGRAM**

Certified Local Government: Carbon County

Address: PO Box 881, 224 Broadway Ave. North, Red Lodge, MT 59068

Contact Person: Rebecca Van Horn

Tax ID: 81:600139

Unique Entity Identifier (UEI): _____

Period of Grant Request: April 1, 2024 to March 31, 2025

Scope of Work: The National Park Service asks we grant funds to CLGs for kinds and levels of work that reflect increasing sophistication, skills, and roles by the Preservation Officers, in other words, tasks that reflect improvement in community thinking. For this section, please itemize special projects, products or projects starting or completing, meetings to be attended, regular work duties, etc., and specifically, ways in which the federal grant funds will help a project or program beneficial to the growth and development of the local program. Please tie your tasks to your community's Preservation Plan. If not, please explain.

Check if Scope of Work is continued on additional pages.)

Organization: Organize and attend Carbon County Historic Preservation Commission meetings to ensure implementation of County-wide preservation activities. Attend workshops and other training, offered online, as provided, to stay current with current Federal and state initiatives. *Part 1 CCPP (Carbon County Preservation Plan)*

Identification: Maintain appropriate records of historic properties in Carbon County. Identify properties that may be eligible for listing in the National Register of Historic Places, and as necessary seek funds to complete nominations. *(Part 3 CCPP)*

Review and Compliance: Assist local governments and Federal agencies with review of actions that may affect historic properties. This may be through formal reviews required by Section 106 or by local ordinances. *(Part 5 CCPP)*

Preservation Planning: Ensure preservation planning is integrated in Carbon County and its communities by attending appropriate meetings, city & town council meetings, local board meetings, and any other public meetings to ensure historic preservation is considered in proposed actions. As appropriate, review and update the Carbon County Historic Preservation Plan and make the plan available to local governments, private and public organizations and the general public. *(Part 5 CCPP)*

Public Education: Participate in public education and outreach by assisting community members and professionals researching historic properties, conducting tours; making public presentations; and assisting the Carbon County Museum in its public outreach activities. *(Part 6 CCPP)*

BUDGET

4-1-2024 to 3-31-2025 Budget	Cash Amount	Cash Source	In-kind Amount	In-kind Source	Total
A. Salaries, Wages, Benefits	\$6,000 \$12,980 \$2,660	F NP NP			\$6,000 \$12,980 \$2,660
B. Office Rental			\$3,000	NP	\$3,000
C. Equipment					
D. Supplies & Materials Itemize major categories	\$700.00	NP			\$700.00
E. Postage	\$700.00	NP			\$700.00
F. Telephone & Internet	\$1,150	NP			\$1,150
G. Photocopies			\$300	NP	\$300
H. Preservation Commission Number of hours X * rate X number of members X number of meetings			3 x \$27.87 x 8 x 4 = \$2,675.52	NP	\$2,675.52
I. Volunteers Hours X * rate X number of volunteers.			30hrs x \$27.87 x 5 = \$4,180.50	NP	\$4,180.50

J. Travel Mileage Number of miles X \$0.67. Include funds for HPO and/or Commissioners to attend CLG annual training	Training:400m i x .67 = \$268.00 Site visit: 150mi x .67= \$100.50 Meetings: 250mi x .67= \$167.50 CCHPC: 300mi x .67= \$201.00	NP NP NP NP			\$737
K. Travel Meals # of Meals X rate: Breakfast - \$8.25 Lunch - \$9.25 Dinner - \$16.00	B: 3 x \$8.25 = \$24.75 L: 3 x \$9.25 = \$27.75 D: 3 x \$16.00 = \$48.00	NP NP NP			\$100.50
L. Lodging \$107.00 plus tax X number of nights	3 x \$107.00 = \$321.00	NP			\$321.00
M. Project (s) Expenses – fully itemized					
N. Other Expenses – fully itemized.					
M. Total Expenses					

SOURCE KEY:
F-Federal
CI-City

CO-County
NP- Private/Non-Profit

* Federally approved minimum rate for volunteers is \$27.87 per hour.

SOURCES OF REVENUE/FUNDING

AMOUNT

Itemized Cash Match Source

<u>Salaries/Wages, Benefits (CCHS)</u>	<u>\$15,640.00</u>
<u>Supplies & Materials (CCHS)</u>	<u>\$ 700.00</u>
<u>Postage (CCHS)</u>	<u>\$ 250.00</u>
<u>Telephone & Internet (CCHS)</u>	<u>\$ 1,150.00</u>
<u>Mileage (CCHS)</u>	<u>\$737</u>
<u>Lodging (CCHS)</u>	<u>\$321.00</u>
<u>Travel Meals (CCHS)</u>	<u>\$100.50</u>

Itemized In-Kind Match Source

<u>Office Rental (CCHS)</u>	<u>\$ 3,000.00</u>
<u>Photocopies (CCHS)</u>	<u>\$ 300.00</u>
<u>Preservation Commission Time</u>	<u>\$2,675.52</u>
<u>Professional Volunteer Time</u>	<u>\$4,180.50</u>
<u>_____</u>	<u>_____</u>
<u>_____</u>	<u>_____</u>
<u>_____</u>	<u>_____</u>

Federal HPF Grant Request from SHPO

<u>Salaries/Wages & Benefits</u>	<u>\$6,000</u>
--------------------------------------	----------------

TOTAL REVENUE	<u>\$35,054.52</u>
----------------------	---------------------------

**Certified Local Government
Historic Preservation Commission Chairperson or President**

Signature [Handwritten Signature] Date 02-02-24

Name (typed) Matt Stump

Address 118 S. Park St., Joliet, MT 59041

Telephone 4069629838

**Certified Local Government
Chief Elected Official**

Signature _____ Date _____

Name (typed) Scott Miller

Title Chief Elected Official (Presiding Officer)

Address P.O. Box 887, Red Lodge, MT, 59068

Telephone 409-446-1595

(The local government administrator may sign in **addition** to the Chief Elected Official.)

**Certified Local Government
Historic Preservation Officer**

Signature _____ Date _____

Name (typed) Rebecca Van Horn

Address PO Box 2368 Red Lodge, MT 59068

Telephone (406) 446-3667

Please attach the meeting minutes (or an alternate way in writing) at which your application was discussed and approved by the Preservation Board/Commission.

Please attach a list of the historic preservation board members' names citizen membership, terms (year ending), their professional discipline or status as a citizen member on the board, and contact information.